



2016 ANNUAL MEETING

*November 9 - 12
Austin, Texas*

JW Marriott Austin

BRAIN, MIND AND BODY:

**Why Every PM Psychiatrist
Should Care About Neuroscience**



ACADEMY OF
PSYCHOSOMATIC
MEDICINE



Final Program
#apm16tx

WELCOME TO APM'S

TABLE OF CONTENTS

Welcome to APM's 2016 Annual Meeting	2
Accreditation	4
Annual Meeting Subcommittees	5
Schedule and Program Details	6
Tuesday, Nov. 8	6
Wednesday, Nov. 9	6
Thursday, Nov. 10	9
Poster Session	16
Friday, Nov. 11	27
APM 2016 Awards	31
Saturday, Nov. 12	39
Sunday, Nov. 13	44
Short Guide to the Best of Austin	45
Committee & SIG Meetings	47
Foundation of the Academy of Psychosomatic Medicine	48
Live Learning Center Ad	49
Hotel Maps	50
A Guide to Using the APM 2016 App	52
APM Disclosure Reporting	53
Meeting Notes	55
Ads	57
APM Membership	59

On behalf of the Academy of Psychosomatic Medicine, we're happy to welcome you to APM 2016 in Austin, Texas, the Live Music Capital of the World, a city where the BBQ is so good some places don't have closing hours, they just run out of food.

This promises to be a compelling and truly educational Scientific Program. APM President Steve Epstein, MD, FAPM, has chosen a conference theme of "Brain, Mind and Body: Why Every PM Psychiatrist Should Care About Neuroscience". Enhanced knowledge of clinical neuroscience can greatly improve assessment and treatment of the many PM patients with complex neuropsychiatric conditions. The meeting will include plenary sessions from neuroscience experts, practical sessions on the treatment of neuropsychiatric patients, and additional content to educate attendees about the latest findings in neuroscience relevant to the day-to-day practice of Psychosomatic Medicine. Annual Meeting Chair Jeff Huffman, MD, FAPM, working with an extremely dedicated and talented Annual Meeting Committee, has labored for the last year to realize Dr. Epstein's vision.

Here's a preview of what you can experience at the 2016 APM Annual Meeting:

- ★ An all-day preconference "Essentials of Psychosomatic Medicine" course, featuring 11 expert speakers teaching the most up-to-date information in core topics; in addition, we are offering eight skills-based courses for a more in-depth exploration of challenging areas of Psychosomatic Medicine
- ★ A Wednesday evening special session, tackling the controversy about whether collaborative care can actually be implemented in the real world, "Collaborative Care: Pipeline or Pipe Dream?" features Kurt Kroenke, MD, Michael Sharpe, MD, FAPM, and Peter Shapiro, MD, FAPM, with Carol Alter, MD, FAPM, moderating
- ★ The next three days will be filled with novel, practical, and exciting content crossing all areas of PM. Three plenary speakers highlight the agenda: Mark Hallett, MD, will showcase his innovative work on the pathophysiology of functional movement disorders, which will include his fascinating neuroimaging research in patients with these conditions. Andrew Miller, MD, will discuss work on the emerging role of the immune system in depression, with data from his neuroimaging and biomarker research. Stuart Yudofsky, MD, will provide a practical lecture utilizing his many years of research and clinical work in neuropsychiatry in his session on "Advanced Management of Agitation and Aggression in Patients with Neuropsychiatric Disorders"

2016 ANNUAL MEETING

- ★ Other special invited sessions include a plenary debate on Saturday between Ted Stern, MD, FAPM, and Jose Maldonado, MD, FAPM, on “Controversial Topics in Clinical PM,” moderated by APM Councilor Christina Wichman, DO, FAPM. They will debate on delirium, alcohol withdrawal, chronic fatigue syndrome and a mystery topic selected by *you*, the participants! Finally, an invited symposium on Friday on “Neuropsychiatric Manifestations of Infectious Disease” from experts Susan Swedo, MD, and Brian Fallon, MD, which will focus on Lyme disease, PANDAS, and related syndromes
- ★ 160 scientific posters; 11 oral paper sessions, including the Webb Fellows’ presentations; 66 general sessions
- ★ Myriad social and networking events to promote networking opportunities for both experienced and new meeting attendees
- ★ Up to 30 hours of CME credit that can be earned over the four days of the meeting.

With hundreds of abstract submissions, the competition for a place on the program was intense. We have selected the very best that will offer you a wealth of ideas and a cornucopia of cutting-edge research in venues ranging from plenaries and a poster session, to general sessions, and concurrent paper presentations.

We look forward to engaging with you in this compelling and mind-expanding program, the pinnacle of APM’s year, a testimony to the vitality of our organization and its importance in our professional lives.

2016 Annual Meeting Committee



Jeff Huffman,
MD, FAPM,
Chair



Lisa Seyfried,
MD, FAPM,
Vice Chair



Pierre Azzam,
MD, FAPM,
Member



Scott Beach,
MD, FAPM,
Member



Anne Gross,
MD, FAPM,
Member



Kristin Somers,
MD, FAPM,
Member



Thomas Heinrich,
MD, FAPM,
CME Liaison



Sandra Rackley,
MD, FAPM,
Consultant



Philip Bialer,
MD, FAPM,
Advisor

ACCREDITATION

2015-2016 APM COUNCIL

President

Steve Epstein, MD, FAPM

President-Elect

Robert Boland, MD, FAPM

Vice President

James Rundell, MD, FAPM

Treasurer

Rebecca Brendel MD, JD, FAPM

Secretary

Michael Sharpe, MD, FAPM

Immediate Past President

Catherine Crone, MD, FAPM

Councilors

Madeleine Becker, MD, FAPM

Philip Bialer, MD, FAPM

J. Michael Bostwick, MD, FAPM

Paul Desan, MD, PhD, FAPM

Jeff Huffman, MD, FAPM

Robert Joseph, MD, FAPM

Maryland Pao, MD, FAPM

Maria Tiamson-Kassab, MD, FAPM

Christina Wichman, DO, FAPM

Linda Worley, MD, FAPM

(Governor)

Editor, Psychosomatics

Theodore Stern, MD, FAPM

Chair, Foundation of APM

Carol Alter, MD, FAPM

Executive Director

James Vrac, CAE

ACCME Accreditation Statement

This activity has been planned and implemented in accordance with the accreditation requirements and policies of the Accreditation Council for Continuing Medical Education through the joint providership of The Medical College of Wisconsin and the Academy of Psychosomatic Medicine. The Medical College of Wisconsin is accredited by the ACCME to provide continuing medical education for physicians.

AMA Credit Designation Statement

The Medical College of Wisconsin designates this Live Activity for a maximum of 30.00 AMA PRA Category 1 Credit(s)™. Physicians should claim only the credit commensurate with the extent of their participation in the activity.

Hours of Participation for Allied Health Care Professionals

The Medical College of Wisconsin designates this activity for up to 30.00 hours of participation for continuing education for allied health professionals.

Learning Objectives

At the end of this meeting, participants will be able to:

- ★ Apply patient outcomes research findings to clinical care scenarios for persons with comorbid psychiatric and general medical conditions.
- ★ Approach the hospitalized, demoralized patient with bedside therapy techniques.
- ★ Appreciate the importance of patients' stories – their psychosocial narratives – in tailoring individualized treatment plans responsive to their personal needs.
- ★ Define the intersection of communication in Psychosomatic Medicine and professional formation
- ★ Improve and expand knowledge about improving the medical outcomes of chronically and persistently mentally ill patients.
- ★ Describe the impact of the electronic medical record on doctor to doctor communication.

ANNUAL MEETING SUBCOMMITTEES

Early Career Track

Kristin Somers, MD, FAPM, Co-chair
John Taylor, MD, Co-chair
Alan Bates, MD, PhD
Rebecca Brendel, MD, JD, FAPM
Anne Gross, MD, FAPM
Alan Hsu, MD
Katy Lalone, MD
Mark Oldham, MD
J.J. Rasimas, MD, PhD, FAPM
Sparsha Reddy, MD
Samata Sharma, MD
Charles Surber, MD
Fawad Taj, MD

Local Arrangements

Anne Gross, MD, FAPM, Co-chair
Laura Kent, MD, FAPM, Co-chair
Sean Allan, MD
Carol Alter, MD, FAPM
Scott Babe, MD
Scott Beach, MD, FAPM
Christina Bilyeu, MD
Mary Jo Fitz-Gerald, MD, FAPM
Amanda Green, MD
Kim Hartney, MD
Manon Mashburn, MD
Leeza Park, MD, FAPM
Michael Rafferty, MD
Ann Schwartz, MD, FAPM
Jorge Sotelo, MD, FAPM
Lee Tynes, MD, PhD
Marcus Wellen, MD

Oral Papers & Posters

Jon Levenson, MD, FAPM, Co-chair
Christina Wichman, DO, FAPM, Co-chair
Janna Gordon-Elliott, MD, FAPM,
Co-chair
Patrick Aquino, MD, FAPM
Bradford Bobrin, MD, FAPM
Jason Caplan, MD, FAPM
M. Beatriz Currier, MD, FAPM
Mary Jo Fitz-Gerald, MD, FAPM
Rita Hargrave, MD
Laura Kent, MD, FAPM
Chloe Nims, MD
Roberto Ortiz-Aguayo, MD, FAPM
Davin Quinn, MD
Terry Rabinowitz, MD, DDS, FAPM
Muhamad Aly Rifai, MD, FAPM
Dahlia Saad Pendergrass, MD
Terry Schneckloth, MD, FAPM
Lisa Seyfried, MD
Sejal Shah, MD

Pre-Conference Courses

Maryland Pao, MD, FAPM, Co-chair
Lisa Rosenthal, MD, FAPM, Co-chair
Rashi Aggarwal, MD, FAPM
Lois Krahn, MD, FAPM
Shelia Lahijani, MD
James Levenson, MD, FAPM
Laura Markley, MD
Leeza Park, MD, FAPM
Divy Ravindranath, MD
Lisa Seyfried, MD
Theodore Stern, MD, FAPM
Robert Weinrieb, MD, FAPM

General Sessions

Sandra Rackley, MD, FAPM, Co-chair
Christopher Sola, DO, FAPM, Co-chair
Sharon Batista, MD, FAPM
Scott Beach, MD, FAPM
James Bourgeois, OD, MD, FAPM
Khyati Brahmabhatt, MD
Syma Dar, MD
Marc Feldman, MD
Marian Fireman, MD, FAPM
Travis Fisher, MD
Thomas Heinrich, MD, FAPM
Manuel Pacheco, MD, FAPM
Laura Prager, MD
Yelizaveta Sher, MD
Gen Shinozaki, MD, FAPM
Christine Skotzko, MD, FAPM
Sanjeev Sockalingam, MD, FAPM
Erin Sterenson, MD
Joel Wallack, MD, FAPM

SCHEDULE AND PROGRAM DETAILS

WEDNESDAY, NOV. 9



TUESDAY, NOV. 8

6:00 – 8:00 PM

Registration Desk open

Griffin Hall

WEDNESDAY, NOV. 9

7:00 AM – 7:00 PM

Registration Desk open

Griffin Hall

8:00 AM – 12:00 noon

Essentials of Psychosomatic Medicine Part 1 [8.0 CME full day]

JW Grand Ballroom 1

EPM01 Delirium Update

Jose Maldonado, MD, FAPM, FACFE, Stanford University, Stanford, CA

EPM02 Updates in Women's Mental Health

Christina Wichman, DO, FAPM, Medical College of Wisconsin, Muskego, WI

EPM03 Updates in Cardiac Psychiatry

Scott Beach, MD, FAPM, Massachusetts General Hospital, Boston, MA

EPM04 Functional and Somatic Symptom Disorders

Jeffrey Staab, MD, FAPM, Mayo Clinic, Rochester, MN

EPM05 Essentials of Psychopharmacology in the Medically Ill

Laura Markley, MD, FAPA, FAAP, Akron Children's Hospital, Akron, OH

EPM06 Selected Legal Issues in Psychosomatic Medicine

Rebecca Brendel, MD, JD, FAPM, Harvard Medical School, Boston, MA

SCHEDULE AND PROGRAM DETAILS

WEDNESDAY, NOV. 9

8:00 AM – 12:00 noon

Concurrent Skills Courses [4.0 CME]

SC1 The National Neuroscience Curriculum Initiative: Bringing Neuroscience into the Clinical Practice of Psychiatry

201

Robert Boland, MD, Brigham and Women's Hosp/Harvard Medical School, Boston, MA
Michael Travis, MD, University of Pittsburgh, Pittsburgh, PA
David Ross, MD, PhD, Yale University, New Haven, CT
Melissa Arbuckle, MD, PhD, Columbia University Medical Center, New York, NY
Katherine Blackwell, MD, PhD, Institute of Living, Hartford, CT

SC2 "Tackling the Problem Head-On": Controversies in Psychiatric Diagnosis and Management After Traumatic Brain Injury

202

Davin Quinn, MD, UNM Center for Brain Recovery and Repair, Santa Fe, NM
Durga Roy, MD, Johns Hopkins University School of Medicine, Baltimore, MD
Shamim Nejad, MD, Swedish Cancer Institute & Swedish Medical Center, Seattle, WA
Daniel Daneshvar, MD, PhD, Boston University CTE Center, Boston, MA
Jesse Fann, MD, FAPM, University of Washington, Seattle, WA

SC3 Transplant Psychiatry

203

Yelizaveta Sher, MD, Stanford University, Stanford, CA
Jose Maldonado, MD, FAPM, FACFE, Stanford University, Stanford, CA
Thomas Beresford, MD, VAMC/University of Colorado, Denver, CO
Jaroslava Salman, MD, City of Hope, Duarte, CA
Marian Fireman, MD, FAPM, Oregon Health and Science University, Portland, OR
Sheila Jowsey-Gregoire, MD, Mayo Clinic, Rochester, MN
Paula Zimbrea, MD, FAPM, FAPA, Yale University, New Haven, CT
Akhil Shenoy, MD, Icahn School of Medicine at Mount Sinai, New York, NY

SC4 A Psychosomatic Guide to Antiretroviral and Psychotropic Medication Management for HIV Care Across the Lifespan

204

Kelly Cozza, MD, DFAPA, FAPM, Uniformed Services University of the Health Sciences,
Washington, DC
Adriana Carvalho, MD, PhD, University of Toronto, Toronto, ON, Canada
Jordi Blanch, MD, PhD, Hospital Clinic de Barcelona, Barcelona, Spain
Luis Pereira, MD, Icahn School of Medicine at Mount Sinai, New York, NY
Elise Hall, MD, FRCPC, University of Toronto, St. Michael's Hospital, Toronto, ON, Canada
Rita Rein Richardson, MD, Walter Reed National Military Medical Center, Kensington, MD
Betsy Kennard, PsyD, University of Texas Southwestern Medical Center at Dallas, Dallas, TX

12:00 noon – 1:00 PM

Lunch on your own, or hosted lunch available for \$25

JW Grand Ballroom 4

SCHEDULE AND PROGRAM DETAILS

WEDNESDAY, NOV. 9

1:00 – 5:00 PM

Essentials of Psychosomatic Medicine Part 2

JW Grand Ballroom 1

EPM07 Medical Toxicology

J.J. Rasimas, MD, PhD, FAPM, Hennepin County Medical Center, Minneapolis, MN

EPM08 Essentials of Dementia

Jason Caplan, MD, FAPM, Creighton University, Phoenix, AZ

EPM09 Bedside Neuropsychiatric Assessment: Focus on Executive Function

Stephen Nicolson, MD, FAPM, Beth Israel Deaconess Hospital, Plymouth, MA

EPM10 Transplant Psychiatry Review

Andrea DiMartini, MD, FAPM, University of Pittsburgh, Pittsburgh, PA

EPM11 Update in Psycho-oncology

Donald Rosenstein, MD, FAPM, University of North Carolina, Chapel Hill, NC

1:00 – 5:00 PM

Concurrent Skills Courses [4.0 CME each]

SC5 Acute Brain Failure: Neurobiology, Prevention and Treatment of Delirium

201

Jose Maldonado, MD, FAPM, FACFE, Stanford University, Stanford, CA

SC6 Palliative Care, Decisional Capacity, and Neuroscience - A Palliative Care and Bioethics Collaborative SIG Pre-conference Workshop

202

James Bourgeois, OD, MD, FAPM, University of California, San Francisco, CA

Samidha Tripathi, MD, University of Arkansas for Medical Sciences, Little Rock, AR

Henry Bleier, MD, Perelman School of Medicine, University of Pennsylvania, Philadelphia, PA

Harold Goforth, MD, FAPM, Cleveland Clinic, Cleveland, OH

J.J. Rasimas, MD, PhD, FAPM, Hennepin County Medical Center, Minneapolis, MN

Mary Ann Cohen, MD, FAPM, FACP, DLFAPA, FAAPDP, Icahn School of Medicine at Mount Sinai, New York, NY

Jennifer Erickson, DO, University of Washington, Mercer Island, WA

SC7 Using ECT to Treat the Brain, Mind and Body of Medically Complex and Critically Ill Patients

203

Terry Rabinowitz, MD, DDS, FAPM, FAPA, FATA, University of Vermont College of Medicine, Burlington, VT

Keith Rasmussen, MD, Mayo Clinic, Rochester, MN

A Evan Eyler, MD, DFAPA, University of Vermont College of Medicine, Burlington, VT

Stephen O'Donnell, MD, University of Vermont Medical Center, Burlington, VT

SC8 Neuroradiology for the Consult-Liaison Psychiatrist

204

Michelle Nichols, MD, FAPA, Baylor University Medical Center at Dallas, Dallas, TX

Greg dePrisco, MD, Baylor University Medical Center at Dallas, Dallas, TX

1:00 – 5:00 PM



APM Council Meeting (first)

401

Council members & invited guests only

SCHEDULE AND PROGRAM DETAILS

WEDNESDAY, NOV. 9

5:00 – 6:00 PM	Psychosomatics Editorial Board Meeting	209
	By invitation only	
5:00 – 7:00 PM	New Member, First-Time Attendee, Trainee, and Early Career Mixer	Congress Avenue Terrace Level 5, pool side
	By invitation only	
5:15 – 7:00 PM	PM/C-L Fellowship Directors' Forum	208
	Fellowship program directors and fellowship trainees	
7:00 – 8:30 PM	Bringing Collaborative Care to Clinical Practice: Pipeline or Pipe Dream? A Lecture and Interactive Debate [1.5 CME]	203/204
	Moderator/Discussant:	
	• Carol Alter, MD, FAPM , Mindoula Health, Bethesda, MD	
	Invited speakers:	
	 Kurt Kroenke, MD Indiana University School of Medicine, Indianapolis, IN	
	 Michael Sharpe, MD, FAPM University of Oxford, Oxford, United Kingdom	
	 Peter Shapiro, MD, FAPM, FAPA Columbia University Medical Center, New York, NY	

THURSDAY, NOV. 10

6:00 – 6:45 AM	Neighborhood Run	Meet in hotel lobby
6:30 AM – 6:00 PM	Registration Desk open	Griffin Hall
7:00 – 7:45 AM	Mindfulness Meditation with Paul Jones, MD	504
7:00 – 7:45 AM	APM Committee Meetings	See page 47
	APM committee members only	
7:00 – 8:30 AM	Exhibitor set-up	JW Grand Ballroom Foyer
8:30 AM – 5:00 PM	Exhibits open	JW Grand Ballroom Foyer
7:45 – 8:00 AM	Light refreshments	JW Grand Ballroom Foyer
8:00 – 8:15 AM	Annual Meeting Opening & Announcements	JW Grand Ballroom 5/6

SCHEDULE AND PROGRAM DETAILS

THURSDAY, NOV. 10

8:15 – 9:45 AM

President's Symposium Part 1: Sad and Angry: What Neuropsychiatry Can Tell Us About Treating Negative Emotional States [1.5 CME]

JW Grand Ballroom 5/6

Introduction by: **Jeff Huffman, MD, FAPM**, Annual Meeting Program Chair

When Inflammation Weeps: The Emerging Role of the Immune System in Depression



Andrew Miller, MD

Professor of Psychiatry and Behavioral Sciences, Emory University School of Medicine, Atlanta, GA

The Assessment and Psychopharmacological Treatment of Aggression and Agitation Associated with Neuropsychiatric Disorders



Stuart Yudofsky, MD

Distinguished Professor Emeritus, Menninger Department of Psychiatry, Baylor College of Medicine, Baylor College of Medicine, Houston, TX

9:45 – 10:15 AM

Break

JW Grand Ballroom Foyer

10.15 – 11:45 AM

10 Concurrent General Sessions [1.5 CME]

GS01 Advances in Addiction Psychiatry: What C-L Psychiatrists Need to Know

203/204

ADP

Rashi Aggarwal, MD, FAPM, Rutgers New Jersey Medical School, Newark, NJ

Douglas Opler, MD, Rutgers New Jersey Medical School, Newark, NJ

Erin Zerbo, MD, Rutgers New Jersey Medical School, Little Falls, NJ

Vicki Kalira, MD, New York University Langone Medical Center, Brooklyn, NY

GS02 Establishing Meaningful, Patient-Centered Quality Metrics in Psychosomatic Medicine: Progress and Remaining Challenges

JW Grand Ballroom 1

ADM

David Kroll, MD, Brigham and Women's Hospital, Boston, MA

Stephanie Smith, MD, Partners In Health, Cambridge, MA

Scott Simpson, MD, Denver Health Medical Center, Denver, CO

David Gitlin, MD, FAPM, DFAPA, Brigham and Women's Hospital, Boston, MA

Steve Epstein, MD, FAPM, Georgetown University School of Medicine, Bethesda, MD

GS03 Two Sides of the Same Organ: Hot Topics in Neurology for Psychiatrists

JW Grand Ballroom 2

BCN

Elie Isenberg-Grzeda, MD, Sunnybrook Health Sciences Centre, Toronto, ON, Canada

Kathleen Sheehan, MD, DPhil, University Health Network, Toronto, ON, Canada

David Tang-Wai, MDCM FRCPC, University of Toronto, Toronto, ON, Canada

Matthew Burke, MD, University of Toronto, Toronto, ON, Canada

GS04 Teaching Essential Neuroscience in an Era of Standardized Evaluation and Curricular Reform

201/202

EDT

Theodore Stern, MD, FAPM, Harvard Medical School, Boston, MA

Anne Gross, MD, FAPM, Oregon Health & Science University, Portland, OR

Ann Schwartz, MD, FAPM, Emory University School of Medicine, Atlanta, GA

Deanna Chaukos, MD, Massachusetts General Hospital, Boston, MA

Felicia Smith, MD, Massachusetts General Hospital, Boston, MA

Robert Boland, MD, Brigham and Women's Hosp/Harvard Medical School, Boston, MA

SCHEDULE AND PROGRAM DETAILS

GS05 Physician-Assisted Suicide: A Psychiatric Paradox or a Paradigm Shift?

Brazos

ETH

Maria Theresa Mariano, MD, FAPA, FRCPC, Richmond Hospital, Richmond, BC, Canada

James Wilkins, MD, DPhil, Partners HealthCare, Boston, MA

James Bourgeois, OD, MD, FAPM, University of California, San Francisco, San Francisco, CA

Rebecca Brendel, MD, JD, FAPM, Harvard Medical School, Boston, MA

Linda Ganzini, MD, FAPM, VA Portland HCS, Portland, OR

GS06 Advances in Brain-Gut Psychiatry: Using Neuroscience to Treat Obesity Related Psychopathology

JW Grand Ballroom 3

MSP

Omair Abbasi, MD, Thomas Jefferson University Hospital, Philadelphia, PA

Sanjeev Sockalingam, MD, FAPA, FAPM, University Health Network, University of Toronto, Toronto, ON, Canada

Raed Hawa, MD, FRCP, DABPN, University Health Network, University of Toronto, Toronto, ON, Canada

Cathy Crone, MD, FAPM, George Washington University Medical Center, Falls Church, VA

GS08 Novel Approach for Delirium Prevention, Prediction, Screening and Treatment: New Pharmacotherapy, Machine Learning Approach and Newly Developed EEG Device

JW Grand Ballroom 4

NEP

James Rundell, MD, FAPM, Uniformed Services University of the Health Sciences School of Medicine, Bethesda, MD

Yasuhiro Kishi, MD, PhD, FAPM, Nippon Medical School Musashikosugi Hospital, Kawasaki, Japan

John Cromwell, MD, University of Iowa, Iowa City, IA

Gen Shinozaki, MD, FAPM, University of Iowa, Iowa City, IA

J.J. Rasimas, MD, PhD, FAPM, Hennepin County Medical Center, Minneapolis, MN

GS09 Treatment of the Psychiatric Patient in Crisis in the Emergency Department

402/403

POT

Leslie Zun, MD, FAAEM, Chicago Medical School, Chicago, IL

Divy Ravindranath, MD, Palo Alto VAHCS, Palo Alto, CA

Victor Stiebel, MD, FAPM, University of Pittsburgh Medical Center, Pittsburgh, PA

Constanza Martinez Piñanez, MD, Freeman Health System, Joplin, MO

GS10 The VIP Patient and C-L Psychiatry: The Thorny Business of Consulting on Celebrities and Other "Special" Patients

211/212

PLI

Philip Muskin, MD, FAPM, Columbia University, New York, NY

Anna Dickerman, MD, FAPA, Weill Cornell Medical College, New York, NY

GS11 The Neuroendocrine System in Women's Mental Health: The A-B-Cs of the H-P-G Axis

408/409

WMH

Janna Gordon-Elliott, MD, FAPM, NewYork-Presbyterian/Weill Cornell Medical Center, New York, NY

Carrie Ernst, MD, Icahn School of Medicine at Mount Sinai, New York, NY

Margaret Altemus, MD, Yale School of Medicine, West Haven, CT

Elizabeth Albertini, MD, Icahn School of Medicine at Mount Sinai, New York, NY

Madeleine Fersh, MD, Long Island Jewish Medical Center, New Hyde Park, NY

Shari Lusskin, MD, Icahn School of Medicine at Mount Sinai, New York, NY

THURSDAY, NOV. 10

Program Tracks					
ADP	ADM	BCN	CDE	EDT	ETH
Addictions and Pain	Administration	Basic & Clinical Neuroscience	Career Development & ECP	Education & Training	Ethics, Oncology, and End-of-Life Care
ITC	MSP	NEP	POT	PLI	WMH
Integrated Care	Medical Specialties	Neuropsychiatry	Potpourri	Psychotherapy & Liaison Interventions	Women's Mental Health

SCHEDULE AND PROGRAM DETAILS

THURSDAY, NOV. 10

12:00 – 3:30 PM

Poster set-up by poster presenters

Griffin Hall

12:00 – 1:15 PM

Wayne Katon Research Award Lecture & Lunch [0.75 CME]

JW Grand Ballroom 5/6

Introduction by: **Michael Sharpe, MD, FAPM**

Big Data for Integrative Care



Matthew Hotopf, MRCPsych, PhD

Professor of General Hospital Psychiatry, King's College London, United Kingdom

1:15– 1:30 PM

Break

1:30 – 3:00 PM

10 Concurrent General Sessions [1.5 CME]

GS12 From “Rookie Cookies” to “Tree Shopping”: How Legalization Is Changing the Neuroscience and Clinical Management of Cannabis Use

203/204

ADP

Scott Simpson, MD, Denver Health Medical Center, Denver, CO
Erica Rapp, MD, University of Colorado School of Medicine, Denver, CO
Thida Thant, MD, University of Colorado School of Medicine, Aurora, CO
Dan Nguyen, MD, University of Colorado, Aurora, CO
David Kroll, MD, Brigham and Women's Hospital, Boston, MA

GS13 Of Dopamine, Drugs, Degeneration, and Debility: The Neuroscience of HIV-associated Neurocognitive Disorders - An HIV/AIDS Psychiatry SIG Symposium

201/202

BCN

Brant Hager, MD, University of New Mexico, Albuquerque, NM
Scott Letendre, MD, University of California, San Diego, San Diego, CA
Jordi Blanch, MD, PhD, Hospital Clinic de Barcelona, Barcelona, Spain
Pablo Toro, MD, Pontificia Universidad Catolica de Chile, Santiago, Chile
Max Lichtenstein, MD, Icahn School of Medicine at Mount Sinai, Brooklyn, NY

GS14 A ‘How to’ Primer on Understanding the Real World of Psychiatry: An APM Business Committee and Early Career SIG Seminar

JW Grand Ballroom 4

CDE

Elisabeth Kunkel, MD, FAPM, Thomas Jefferson University, Philadelphia, PA
Sparsha Reddy, MD, Boston VA Healthcare System, West Roxbury, MA
Jennifer Brandstetter, MD, University Hospitals Cleveland Medical Center, Cleveland, OH
Rachna Raisinghani, MD, Private Practice, Prince Frederick, MD
Samata Sharma, MD, VA Boston Healthcare System, Boston, MA
Ronit Dedesma, MD, FAPM, University of North Carolina at Chapel Hill, Chapel Hill, NC

GS15 ‘You Aren’t Gonna Cut on Me!’: Practice, Ethics and Neurobiology of Decisional Capacity and Schizophrenia

JW Grand Ballroom 1

ETH

Michael Peterson, MD, PhD, FAPM, University of Wisconsin, Madison, Madison, WI
Ann Schwartz, MD, FAPM, Emory University School of Medicine, Atlanta, GA
David Banayan, MD, FRCPC, Rush University Medical Center, Chicago, IL
Ketty Thertus, MD, University of Wisconsin School of Medicine and Public Health, Madison, WI

SCHEDULE AND PROGRAM DETAILS

GS16 Collaborative Care Implementation: Best Practices When Building an Interdisciplinary Team

JW Grand Ballroom 2
ITC

Lorin Scher, MD, University of California, Davis School of Medicine, Sacramento, CA
Steven Frankel, MD, University of California Medical Center, San Francisco, CA
Cheri Lattimer, RN, BSN, Case Management Society of America (CMSA), Little Rock, AR
James Bourgeois, OD, MD, FAPM, University of California, San Francisco, San Francisco, CA
Roger Kathol, MD, FACP, Cartesian Solutions, Inc., Burnsville, MN

GS17 Psychoneurology: Treating, Educating and Supporting Patients with Chronic Kidney Disease

JW Grand Ballroom 3
MSP

Paula Zimbrea, MD, FAPM, FAPA, Yale University, New Haven, CT
Jennifer Braverman, MD, FRCPC, University of Toronto, Toronto, ON, Canada

GS18 Advanced Topics in Catatonia

Brazos
NEP

Davin Quinn, MD, UNM Center for Brain Recovery and Repair, Santa Fe, NM
Pierre Azzam, MD, FAPM, University of Pittsburgh Medical Center, Pittsburgh, PA
Jo Ellen Wilson, MD, Vanderbilt University, Nashville, TN
Gregory Fricchione, MD, FAPM, Massachusetts General Hospital, Boston, MA
Scott Beach, MD, FAPM, Massachusetts General Hospital, Boston, MA

GS19 Managing Eating Disorders in Medical Settings: A 2016 Update for Consultation Psychiatrists

402/403
POT

Sanjeev Sockalingam, MD, FAPA, FAPM, University Health Network, University of Toronto, Toronto, ON, Canada
Alexis Fertig, MD, MPH, University of Pittsburgh Medical Center, Pittsburgh, PA
Raed Hawa, MD FRCP DABPN, University Health Network, University of Toronto, Toronto, ON, Canada
Wynne Lundblad, MD, Western Psychiatric Institute and Clinic of UPMC, Pittsburgh, PA

GS20 'My Brain Made Me Do It': Neuropsychiatric Diseases That Lead to Criminal Activity

211/212
PLI

Ayol Samuels, MD, Montefiore Medical Center/Albert Einstein College of Medicine, Bronx, NY
Howard Forman, MD, Montefiore Medical Center/Albert Einstein College of Medicine, Bronx, NY

GS21 Increasing Access to Perinatal Psychiatric Care Across the Nation by Building the Capacity of Front-line Providers

408/409
WMH

Nancy Byatt, DO, FAPM, University of Massachusetts Medical School, Worcester, MA
Christina Wichman, DO, FAPM, Medical College of Wisconsin, Muskego, WI
Carmen Croicu, MD, University of Washington, Redmond, WA
Leena Mittal, MD, FAPM, Harvard Medical School, Boston, MA

THURSDAY, NOV. 10

Program Tracks					
ADP	ADM	BCN	CDE	EDT	ETH
Addictions and Pain	Administration	Basic & Clinical Neuroscience	Career Development & ECP	Education & Training	Ethics, Oncology, and End-of-Life Care
ITC	MSP	NEP	POT	PLI	WMH
Integrated Care	Medical Specialties	Neuropsychiatry	Potpourri	Psychotherapy & Liaison Interventions	Women's Mental Health

3:00 – 3:15 PM

Break

SCHEDULE AND PROGRAM DETAILS

3:15 – 4:45 PM

8 Concurrent General Sessions [1.5 CME]

GS07 Left Ventricular Assist Device Implantation and the Psychosomatic Psychiatrist: Updates on the Management of Chronic Heart Failure and Interactive Case Discussion

211/212

MSP

Alainia Morgan-James, MD, University of Maryland, Baltimore, MD
Jessica Samples, MD, Tennessee Valley Healthcare System, Nashville, TN
Karen Johnson, MD, FAPM, Georgetown University School of Medicine, Washington, DC
Peter Shapiro, MD, FAPM, FAPA, Columbia University, New York, NY

GS22 Collaborative Multi-Disciplinary Approaches to Comprehensive Treatment of Chronic Pain

JW Grand Ballroom 2

ADP

Linden Spital, CRNP, PMHBC, University of Michigan, Ann Arbor, MI
Kelly Wawrzyniak, PsyD, Boston Pain Care, Brookline, MA
Jenna Goesling, PhD, University of Michigan, Ann Arbor, MI
Howard Schubiner, MD, Providence Hospital, Southfield, MI
Elissa Patterson, PhD, University of Michigan Hospital System, Ann Arbor, MI

GS23 How to Create a Successful Business Plan: A Workshop Sponsored by the APM Business of Psychosomatic Medicine Subcommittee

402/403

ADM

Brian Bronson, MD, Stony Brook University, Stony Brook, NY
Thomas Heinrich, MD, FAPM, Medical College of Wisconsin, Milwaukee, WI
Junji Takeshita, MD, John A. Burns School of Medicine, University of Hawaii, Honolulu, HI
Andrew Currivan, MSN, Queens Medical Center, Honolulu, HI
Elisabeth Kunkel, MD, FAPM, Thomas Jefferson University, Philadelphia, PA

GS24 An Animated Journey in Neuroprotection

JW Grand Ballroom 1

BCN

David Banayan, MD, FRCPC, Rush University Medical Center, Chicago, IL
Michael Marcangelo, MD, FAPM, FAPA, University of Chicago, Chicago, IL
Kirk Harris, MD, Rush University Medical Center, Chicago, IL
Marie Tobin, MD, University of Chicago, Chicago, IL

GS25 Rounds in the General Hospitals: Turning Clinical Care and Presentations into Publishable Manuscripts

203/204

CDE

Theodore Stern, MD, FAPM, Harvard Medical School, Boston, MA
Ann Schwartz, MD, FAPM, Emory University School of Medicine, Atlanta, GA
Margo Funk, MD, VA Southern Oregon Rehabilitation Center and Clinics, Medford, OR
Philip Muskin, MD, FAPM, Columbia University, New York, NY
Donald Rosenstein, MD, FAPM, University of North Carolina, Chapel Hill, NC
Madeleine Becker, MD, FAPM, Thomas Jefferson University Hospital, Philadelphia, PA
Anne Gross, MD, FAPM, Oregon Health & Science University, Portland, OR

GS26 Updates in Psycho-oncology for Psycho-oncologists

JW Grand Ballroom 3

ETH

Eliza (Leeza) Park, MD, FAPM, University of North Carolina at Chapel Hill, Chapel Hill, NC
Fremonta Meyer, MD, FAPM, Brigham and Women's/Dana-Farber Cancer Center, Boston, MA
Rachel Lynn, MD, UT MD Anderson Cancer Center, Houston, TX
Ilana Braun, MD, FAPM, Dana-Farber Cancer Institute, Boston, MA
Julia Kearney, MD, Memorial Sloan Kettering Cancer Center, New York, NY
Andrew Roth, MD, Memorial Sloan Kettering Cancer Center, New York, NY

GS27 Ethnic and Gender Differences in Psychotropic Drug Metabolism and Its Clinical Implications: Focus on Pharmacogenetic Studies

JW Grand Ballroom 4

POT

Terry Rabinowitz, MD, DDS, FAPM, FAPA, FATA, University of Vermont College of Medicine, Burlington, VT
Eric Meyer, MD, FAPA, Uniformed Services University of the Health Sciences, Bethesda, MD
Julia Adler, MD, California Pacific Medical Center, San Francisco, CA
Victor Torres-Collazo, MD, Geisel School of Medicine at Dartmouth College, San Francisco, CA
H. Paul Chin, MD, California Pacific Medical Center, San Francisco, CA

THURSDAY, NOV. 10

SCHEDULE AND PROGRAM DETAILS

GS28 Dealing with Deceptive Patients

Brazos

PLI

Scott Beach, MD, FAPM, Massachusetts General Hospital, Boston, MA
Nicholas Kontos, MD, Massachusetts General Hospital, Boston, MA
John Taylor, MD, Massachusetts General Hospital, Cambridge, MA
Jonathan Smith, MD, Vanderbilt University Medical Center, Nashville, TN
Amanda Wilson, MD, Vanderbilt University Medical Center, Nashville, TN

DL1 Don R. Lipsitt Award Workshop: Collaborative Care: from Research to Practice

201/202

Introduction by: **Jeff Huffman, MD, FAPM**



Jürgen Unützer, MD
 Professor and Chair, University of Washington School of Medicine, Seattle, WA

THURSDAY, NOV. 10

5:15 – 7:45 PM	Poster Session [2.5 CME] See poster titles/authors listed on pages 16-27	Griffin Hall
6:15 – 8:30 PM	Welcome Reception Drinks, light appetizers, live music. See p45 for post-reception dining options.	Griffin Hall
8:30 – 10.00 PM	Foundation of the APM Reception	Per invitation



November 9-12
Austin, Texas

Need the Presentation? Get the App!

Apple iOS Devices - Search for "APM 2016" on Apple's App Store.
 Android Devices - Search for "APM 2016" on Google Play.



POSTER SESSION

POSTER SESSION

5:15 - 7:45 PM

Poster Session [2.5 CME]

Griffin Hall

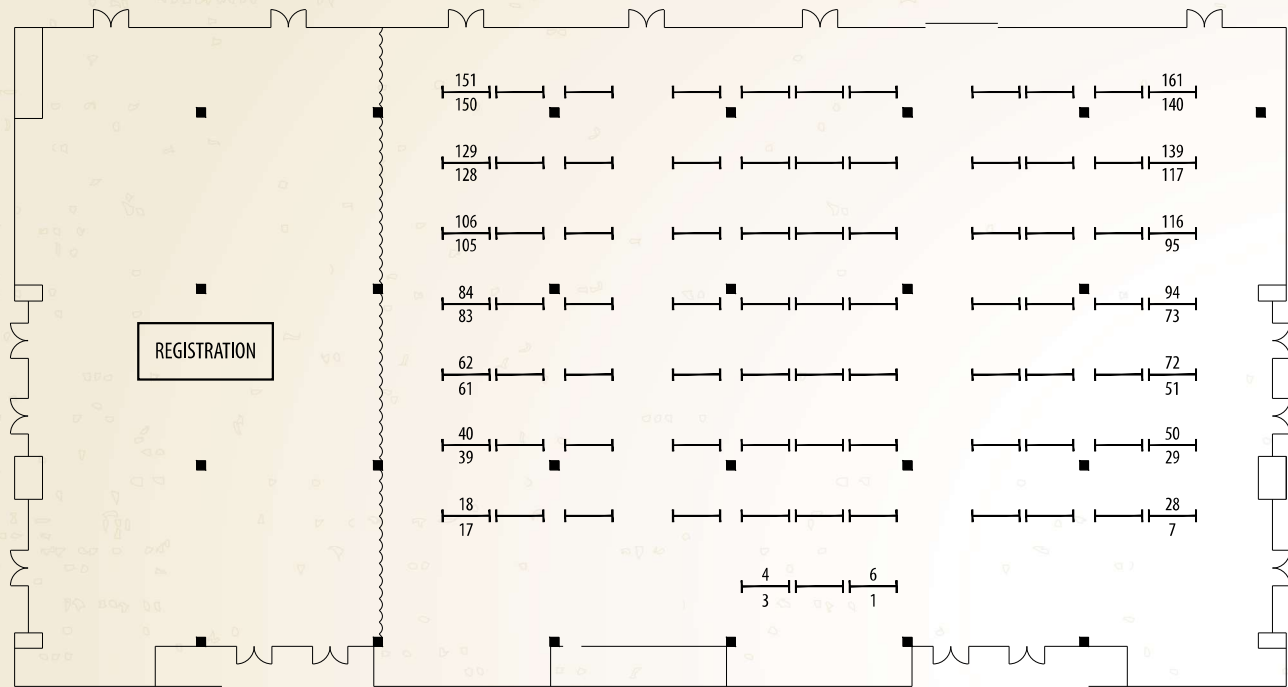

THURSDAY, NOV. 10

Posters are organized into the following sections:

Section	Poster numbers	Section	Poster numbers
Child & Adolescent Psychiatry	2-6	Obesity, Nutrition & Eating Disorders	87-92
Collaborative & Integrated Care	7-17	Palliative Care & Psycho-oncology	93-101
Delirium	18-27	Psychopharmacology & Toxicology	102-123
Hospital Psychiatry	28-39	Somatic Symptom Disorders	124-129
Infectious Disease/HIV Psychiatry	40-47	Special Topics	130-139
Neurocognitive Disorders	48-58	Substance Use & Related Disorders	140-146
Neuroimmunology	59-66	Training & Education	147-156
Neuropsychiatry	67-86	Women's Mental Health	157-161

POSTER SESSION

1. **Alan Stoudemire Award: University of Washington Integrated Care Pathway: Psychiatry in Medical Settings**



Presenting Author: Anna Ratzliff, MD, PhD
Director of UW Integrated Care Training Program, University of Washington, Seattle, WA

Section 1: Child & Adolescent Psychiatry

2. **[T] 'I'm Too Sexy for My Age': Examining Changes in Sex Hormone Binding Globulin in Precocious Puberty and Obsessive Compulsive Disorder**
Presenting Author: Alainia Morgan-James
Co-author: Maryland Pao
3. **[T] Using a Behavioral Intervention to Reduce Agitation in a Pediatric Emergency Room**
Presenting Author: Ayol Samuels
Co-authors: Esther Rollhaus, Yehuda Lerea, Sharon Spitzer Sverd, Ana Ozdoba
4. **[T] Pediatric Visual Release Hallucination Syndrome**
Presenting Author: Rajasekhar Kannali
Co-author: Barry Simon
5. **[T] Long-term and Psychiatric Outcome of Ventriculoperitoneal Shunts in Pediatric Patients**
Presenting Author: Narmin Aliji
Co-authors: Susan Turkel, Mark Krieger
6. **[T] Landau Kleffner Syndrome versus Post Encephalitis in 13-year-old with Autism Spectrum Disorder**
Presenting Author: Luba Leontieva
Co-author: David Keith

Section 2: Collaborative & Integrated Care

7. **[T] Polyallergy in the Medical Setting: A Retrospective Chart Review**
Presenting Author: Nicole Shirvani
Co-authors: George Tesar, Xavier Jimenez

8. **Project ECHO Ontario Mental Health: Outcomes from a Novel Telementoring Knowledge Exchange Network with Rural Primary Care Teams**
Presenting Author: Sanjeev Sockalingam
Co-authors: Eva Serhal, Paul Kurdyak, Amanda Arena, Allison Crawford
9. Poster withdrawn
10. **[T] Treating Functional Neurological Disorders in Rehabilitation Settings: A Stepped-care Model**
Presenting Author: Adrienne Taylor
Co-authors: Abhisek Khandai, R Lloyd
11. **[T] The Impact of Project ECHO on Primary Care Outcomes: A Systematic Review**
Presenting Author: Carrol Zhou
Co-authors: Allison Crawford, Eva Serhal, Paul Kurdyak, Sanjeev Sockalingam
12. **Motivational Interviewing to Reduce Risk of Violent Re-injury Among Victims of Urban Violence: A Randomized Clinical Trial**
Presenting Author: Erich Conrad
Co-authors: John Nanney, Joseph Constans
13. **A Five-year Evaluation of a State-wide Implementation of a Consultation-Liaison Telepsychiatry Program**
Presenting Author: Vani Ray
Co-author: Joy Mead-Meucci
14. **[T] Psychiatric Diagnoses Associated with Male Genital Self-mutilation: A Systematic Review**
Presenting Author: Thomas Veeder
Co-author: Raphael Leo
15. **[T] Integrated Care in Two Veterans Administration Hospitals: Resident Assessment of This New System of Care as a Training Experience**
Presenting Author: Larkin Elderon
Co-authors: Brad Stankiewicz, Janet Osterman
16. **[T] Development of a Core Competency Assessment Instrument for Behavioral Care Managers in Collaborative Depression Care Programs**
Presenting Author: Karina Umanskaya
Co-authors: Anna Ratzliff, Emily Benedetto, Melissa Farnum, Hsiang Huang

[T] = Trainee Paper

THURSDAY, NOV. 10

POSTER SESSION

17. **[T] Co-located Perinatal Psychiatry Clinic: Impact of Adding a Psychologist on Clinical Quality Improvement Metrics**

Presenting Author: Deepa Pawar
Co-author: Christina Wichman

Section 3: Delirium

18. **Proactive Psychiatric Consultation in the Medical Intensive Care Unit: A Prospective Cohort Study**

Presenting Author: Dara Wilensky
Co-authors: Christopher Baca, Daniel Talmasov, Shelley Hurwitz, Jennifer Zinser, Melissa Bui

19. **[T] Randomized, Double-blinded, Controlled Trial of Melatonin to Minimize the Prevalence of Delirium in Hospitalized Intensive Care Unit Patients**

Presenting Author: Jordan Rosen
Co-author: Diana Robinson

20. **[T] Utility of Density Spectral Array in the Diagnosis and Management of Delirium**

Presenting Author: Daniel Evans
Co-authors: Aizhan Repchak, Emiliano Valles, Davin Quinn, Arpad Zolyomi

21. **[T] Excited Delirium Syndrome in the Psychiatric Setting: A Series of Five Cases**

Presenting Author: Jason Greenhagen
Co-authors: Nazanin Silver, Lex Denysenko, Madeleine Becker, Keira Chism

22. **[T] Early Delirium Screening in Skilled Nursing Facility Population**

Presenting Author: Anise Noggle
Co-authors: Gabriela D'Jaen, Julia Adler

23. **[T] Disseminated Cryptococcosis Masquerading as Psychotic Disorder in an Immunocompetent Host: A Case Report**

Presenting Author: Jungjin Kim
Co-authors: Adam Prasanphanich, Lauren Gensler, Neguine Rezaii, Wendy Baer, Raymond Young

24. **Improving the Validity of Delirium Screening: A Quality Improvement Project**

Presenting Author: Thomas Heinrich
Co-authors: Steven Denson, Christopher Emanuel, Amy Heidenreich, Stephanie Gresbach, Stanley Lyndon

25. **[T] Rare Case Report of Contrast Induced Encephalopathy Without Supportive Radiological Findings**

Presenting Author: Veeraraghavan Iyer
Co-author: Douglas Opler

26. **Coconut Oil for the Treatment of Delirium: That's Coconutz!**

Presenting Author: Howard Linder
Co-author: Gregory Gunyan

27. **[T] Case Report: Cerebral Amyloid Angiopathy Related Inflammatory Process in a Patient with Fluctuating but Progressive Cognitive Impairment**

Presenting Author: Ryan Rajaram
Co-authors: Mary Willis, Kasia Rothenberg

Section 4: Hospital Psychiatry

28. **Consults for "Suicidal Ideation": Delirium, Depression, Pain ...Tip of the Iceberg!**

Presenting Author: Mehak Sharma
Co-authors: Pochu Ho, Adam Karz, Hande Okan, Vasthie Prudent, Patrick Hou, Yesne Alici

29. **[T] Foreign Body Ingestions in the Inpatient Setting: A Case Review**

Presenting Author: Nicole Bates
Co-authors: Priya Gopalan, Elizabeth Bettinelli

30. **[T] Psychiatric Consultation Referrals and Suicide Attempts over One Year in a Tertiary Care Teaching Hospital on the US/Mexico Border**

Presenting Author: Cynthia Garza
Co-authors: Mona Mojtahedzadeh, Roberto Flores, Amelia Leony-Carrete, Silvina Tonarelli, Henry Weisman

31. **[T] Mis-triage of Patients with Medical Conditions to Psychiatric ER**

Presenting Author: Ateaya Lima
Co-authors: Gregory Haggerty, Andrew Fox, Damir Huremovic, Guitelle St. Victor

THURSDAY, NOV. 10

POSTER SESSION

32. **Exploring the Overlap: A Matrix for Comorbidity, Conflict, Communication and Capacity in Ethics and Psychiatric Consultations**

Presenting Author: Henry Weisman
Co-authors: Cynthia Garza, Silvina Tonarelli

33. **Don't Get Burned Again: Identifying Burn Recidivism as a Crucial Step Towards Tailoring Treatment and Implementing Prevention Strategies**

Presenting Author: Sarah Laughon

34. **[T] The Importance of Differential Diagnosis in New-onset Psychosis: Tales from the C-L Service**

Presenting Author: Shaun Daidone
Co-authors: Matthew Shirazi, Thom Dunn, J. Craig Holland, Abraham Nussbaum

35. **Is the Patient Safe to Go Home? The Geriatric Risk Assessment on the C-L Service**

Presenting Author: David Van Norstrand

36. **[T] Suicide Risk in Adult Medical Inpatients: Is Screening for Depression Enough?**

Presenting Author: Jarrod Smith
Co-authors: Daniel Powell, Deborah Snyder, Elizabeth Ballard, Keenan Withers, Maryland Pao, Lisa Horowitz

37. **[T] Improving Quality of Life Through Music Program in Hospitalized Patients**

Presenting Author: Jeremy Safran
Co-authors: Shuo He, Martin Clark, Vanessa Torres-Llenza

38. **A Case of Delusional Parasitosis on the Psychiatric Consultation Service: A Longitudinal Perspective**

Presenting Author: Adam Trenton
Co-author: Viwek Bisen

39. **Cognitive Impairment Among Acutely Hospitalized Medical Patients: A Hidden Epidemic?**

Presenting Author: Charles Robinson
Co-authors: David Glovinsky, Daniel Todd, Ada Offurum, Mangla Gulati, Seth Himelhoch

Section 5: Infectious Disease/HIV Psychiatry

40. **[T] Implementing HIV-associated Neurocognitive Disorders (HAND) Assessments to Specialty Medication Management in HIV/AIDS and Psychiatric Populations**

Presenting Author: Valerie Oji
Co-authors: Mousa Abkhezr, E. James Essien

41. **[T] Neurosyphilis in a Patient with Newly Diagnosed HIV**

Presenting Author: Subani Maheshwari
Co-author: Inder Kalra

42. **Structural and Functional Cerebral Correlates of HIV-associated Neurocognitive Decline: A MRI Study**

Presenting Author: Pablo Toro
Co-authors: María Elena Ceballos, Juan Ignacio Reculé, Matías Gonzalez, Jorge Calderón, Johannes Schröder

43. **[T] Delusional Parasitosis and HIV**

Presenting Author: Christina Scully
Co-authors: Walter Kilpatrick, John Grimaldi

44. **[T] Delusional Parasitosis in an HIV+ Transgender Female**

Presenting Author: Kate Lieb
Co-authors: María Gomez, Howard Forman, Mary Alice O'Dowd

45. **[T] Herpes Encephalitis or its Cure? A Case of Valacyclovir-associated Neurotoxicity**

Presenting Author: Rachel Hammer
Co-author: James McConville

46. **Treating Bipolar Disorder in People Living with HIV: A Case Series and Review of the Literature**

Presenting Author: Cherlopalle Suneela
Co-authors: Mallika Lavakumar, Ann Avery

47. **[T] Anxiety Treatment in Patients with HIV/AIDS: Evidence-based Recommendations for Treatment in HIV Clinics**

Presenting Author: Nathaniel Sowa

Section 6: Neurocognitive Disorders

48. **A Retrospective Analysis of Neurocognitive Impairment in Older Burn Patients**

Presenting Author: Emily Holmes
Co-author: Sarah Laughon

THURSDAY, NOV. 10

POSTER SESSION

THURSDAY, NOV. 10

49. **[T] 'In Search of Lost Time': The Evaluation and Management of Acute Amnesias**
Presenting Author: Leslie Chavez
Co-authors: Jennifer Erickson, Carmen Casasnovas, Daniel Safin, Davin Quinn
50. **Differential Impact of Low Dose Lorazepam on Executive Function in Cognitively Unimpaired Individuals at Varying Genetic Risk for Alzheimer's Disease**
Presenting Author: Cynthia Stonnington
Co-authors: Brian Harel, Dona Locke, Joseph Hentz, Paul Maruff, Richard Caselli
51. **[T] High Dose Intravenous and Parenteral Thiamine Treatment Improves Outcomes in Medical Decision-making Capacity**
Presenting Author: Marie Rose Alam
Co-authors: Karin Neufeld, Durga Roy
52. **[T] Delusional Misidentification Syndromes: A Case of Capgras Syndrome Following Traumatic Brain Injury**
Presenting Author: Arpita Goswami Banerjee
Co-authors: Inder Kalra, Michael Marino
53. **[T] Temporal Seizure Focus-induced Cotard Syndrome: A Case Study and Literature Review**
Presenting Author: Martha Ignaszewski
Co-author: Walter Kilpatrick
54. **[T] Memory Loss as a Manifestation of Colloid Cyst in a Patient with Schizophrenia: A Case Report**
Presenting Author: Amina Hanif
Co-author: Munaza Khan
55. **[T] Obsessive Compulsive Disorder and Comorbid Process of Neurodegeneration: Case Report and Literature Review**
Presenting Author: Ryan Rajaram
Co-authors: Darlene Floden, Kasia Rothenberg
56. **[T] Boxer's Dementia with Aggression and Sexual Disinhibition: A Case Series**
Presenting Author: Mohamed Eldefrawi
Co-authors: Viviana Chiappetta, Sasidhar Gunturu, Monica Badillo, Marlene Carrillo, Elba Contreras
57. **[T] Korsakoff Syndrome as an Unusual Case of Artery of Percheron Infarction**
Presenting Author: Arushi Kapoor
Co-author: Snezana Sonje
58. **[T] 'Doc, I Think I'm Dead': A Curious Case of Cotard Syndrome**
Presenting Author: Sameera Guttikonda

Section 7: Neuroimmunology

59. **Psychosocial Predictors of Patient Adherence to Disease-modifying Therapies for Multiple Sclerosis**
Presenting Author: Mohammad Alqazlan
Co-authors: Alaa AlMulhem, Hanan AlShalan, Abdulkader Daif, Sanjeev Sockalingam, Fahad Alosaimi
60. **[T] Missed Diagnosis Leading to Missed Opportunity to Preserve CNS Function: A Hashimoto's Story**
Presenting Author: Catherine Lee
Co-authors: Elizabeth Leimbach, Howard Forman, Naalla Schreiber
61. **[T] ECT for the Treatment of Autoimmune Encephalitis-associated Catatonia: A Case Series**
Presenting Author: Blair Walker
Co-authors: Sussann Kotara, Joseph Kugler, Keith Garcia, Samuel Collier, Pamela Lopez
62. **[T] Psychiatrists' Role in Integrated Care: A Case Report of Neuropsychiatric Lupus Requiring Electroconvulsive Therapy**
Presenting Author: Akuh Adaji
Co-author: Thomas Salter
63. **[T] When the Body Attacks the Brain: Revisiting the Diagnostic Challenges of Anti-NMDA Receptor Encephalitis**
Presenting Author: Earl De Guzman
Co-authors: Saad Thara, Beatrice Rabkin, Daniel Holschneider, Patricia Ordorica, Suad Kapetanovic
64. **[T] Chronic Schizophrenia Later Diagnosed with Anti-NMDA Receptor Encephalitis**
Presenting Author: Meghan Conroy
Co-authors: Thomas Finch, Tomer Levin, Alexander Merkler, Joseph Safdieh, Susan Samuels, Janna Gordon-Elliott
65. **[T] When Bipolar Disorder Isn't Bipolar Disorder: A Case of Anti-NMDA-R Encephalitis**
Presenting Author: Christie Urquhart
Co-authors: Shelly Kucherer, Morgan Faeder

POSTER SESSION

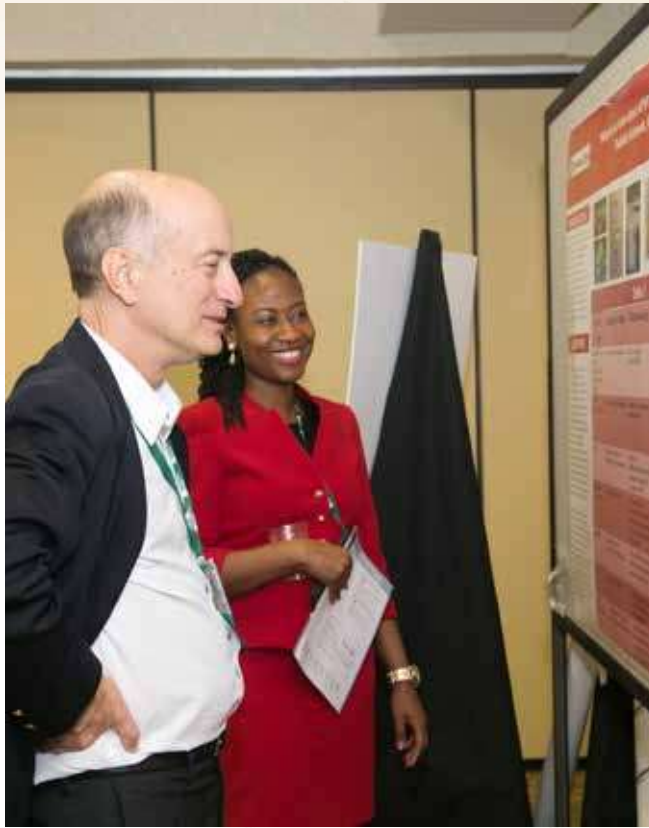

THURSDAY, NOV. 10

POSTER SESSION

66. **[T] Schizophrenia and Myasthenia Gravis: Common Etiology or Unfortunate Coincidence?**

Presenting Author: Katrina Burns
Co-authors: Hugh Seller, Shrestha Angela, Silky Pahlajani, Marie Tobin

Section 8: Neuropsychiatry

67. **[T] Chronic Catatonia Successfully Treated with Transcranial Direct Current Stimulation in a Patient with Cerebral Palsy and Bipolar Disorder**

Presenting Author: Hammam Yahya
Co-authors: Davin Quinn, Michael Hunter, Kevin Wilson, Rebecca Rieger, Vincent Clark

68. **[T] Finding Her Voice: A Case of Dysphonia in an 18-year-old Primigravida Female**

Presenting Author: Christine Clark
Co-authors: Daniel Evans, Dany Bourad, Davin Quinn

69. **[T] Functional Correlates of Shared Neuroanatomical Substrates of Major Psychiatric Disorders**

Presenting Author: Manan Gupta
Co-author: Ram Bishnoi

70. **[T] Psychosis and Schizencephaly: A Case Report and Systematic Review**

Presenting Author: Sasidhar Gunturu
Co-authors: Lauren Schmalz, Liz Vicente, Korenis Panagiota

71. **[T] Apathy as a Final Common Pathway**

Presenting Author: Thida Thant
Co-author: Joel Yager

72. **[T] Overcoming Professional Apraxia and Neglect: Improving the Bedside Examination of the Temporo-parietal Lobes**

Presenting Author: Brian Sparks
Co-authors: Davin Quinn, Daniel Evans

73. **[T] Diagnosis of Catatonia in a General Hospital: The Crucial Role of the Consultation-Liaison Psychiatry Service**

Presenting Author: Joan Roig Llesuy
Co-authors: Joseph Cooper, Michael Marcangelo, Marie Tobin

74. **[T] Severe Mental Illness in a Patient with Asymptomatic White Matter Lesions on Brain MRI: A Case Report**

Presenting Author: Henry Chavez Cuffaro
Co-authors: Gabriela Feier, Carlos Molina Arriola

75. **Talking to God in the Walls: Prolonged Psychosis Associated with Left Insular Stroke**

Presenting Author: Nuria Thusius
Co-author: Christopher Sola

76. **[T] CJD Presenting with Alien Hand Syndrome and Hemineglect in a Consultation for Depression**

Presenting Author: Michel Medina
Co-authors: Kristina Thurin, Zehra Aftab, Joseph Cooper

77. **[T] Post-stroke Depression**

Presenting Author: Naveed Khokhar

78. **[T] A Case of Tic-induced Vertebral Artery Dissection in a Young Man**

Presenting Author: Patricia Pop
Co-author: Sara Nash

79. **[T] Neuropsychiatric Sequelae of Hypoglycemic Coma and Management: Case Series Report**

Presenting Author: Jack Owens
Co-authors: David Daniels, Marie Lord, Murali Rao, Angelos Halaris, Edwin Meresh

80. **[T] Catatonia as a Manifestation of Cerebral Venous Sinus Thrombosis: A Case Report**

Presenting Author: Jessica Butala
Co-authors: Gary Swanson, Amit Chopra, Michael Goldberg

81. **[T] It's in Her Look: A Case of Bilateral Thalamic Infarcts Presenting as Pinpoint Pupils**

Presenting Author: Daniela Rakocevic
Co-authors: Kristen Schmidt, J. Michael Bostwick

82. **[T] Bizarre Behavior and Visual Hallucinations: A Rare Case of Psychosis Following Traumatic Brain Injury**

Presenting Author: Alan Yancovitch
Co-authors: Jennifer Erickson, Joel Wallack, Kenneth Ashley, Carmen Casasnovas, Daniel Safin, Seema Quraishi

THURSDAY, NOV. 10

POSTER SESSION

83. **[T] Beyond the Blood Brain Barrier: Examining Psychiatric Issues Among Neurosurgical Patients Post-operatively; a Scoping Review and a Retrospective Cohort Study**

Presenting Author: Alvin Bryan Keng
Co-author: Kathleen Sheehan

84. **[T] A Case of Pituitary Adenoma and New Onset Psychosis: Causation or True-true and Unrelated?**

Presenting Author: Elyssa Barron
Co-authors: Ayol Samuels, Adam Goldman-Yassen, Howard Forman, Mary Alice O'Dowd

85. **[T] A Case of Frontal Lobe Abulia Masquerading as Depression**

Presenting Author: Lakshit Jain
Co-author: John Gurski

86. **[T] Ballismus, Mania and the Caudate Nucleus**

Presenting Author: Patricia Serrano
Co-authors: John Gurski, Raja Mogallapu

Section 9: Obesity, Nutrition & Eating Disorders

87. **[T] Bariatric Surgery and Long Term Psychiatric Morbidity**

Presenting Author: Aos Mohammed Ameen
Co-authors: Korenis Panagiota, Ryan Rios, Mohamed Eldefrawi

88. **Delusions of Perception and Restricting Food: The Role of the Consult Psychiatrist**

Presenting Author: Shelly Kucherer
Co-authors: Pierre Azzam, Priya Gopalan, Julie Graziane, Wynne Lundblad

89. **[T] Psychiatric Manifestations of Hyperammonemia Encephalopathy Following Roux-en-Y Gastric Bypass**

Presenting Author: Kristin Borreggine
Co-authors: Daniel Hosker, Teresa Rumman, Dennis Manning

90. **[T] Consultation Challenges with Apparent Capacity in Anorexia Nervosa**

Presenting Author: Christie Urquhart
Co-authors: Shelly Kucherer, Frank Fetterolf, Abhishek Jain, Wynne Lundblad, Alexis Fertig

91. **Improvement in Neurocognition Following Bariatric Surgery: An Evidence-based Systematic Review**

Presenting Author: Sanjeev Sockalingam
Co-authors: Gurmeet Thiara, Michela Cigliobianco, Alexei Muravsky, Riccardo Paoli, Rodrigo Mansur, Raed Hawa, Roger McIntyre

92. **[T] Avoidant Restrictive Food Intake Disorder (ARFID): Clinical Evaluation and Treatment of Adults in an Inpatient General Hospital**

Presenting Author: Kristina Thurin
Co-authors: Zehra Aftab, Michael Marcangelo, Marie Tobin

Section 10: Palliative Care & Psycho-oncology

93. **[T] The Impact of Pathological Denial on Basal Cell Carcinomas: Case Report and Review of the Literature**

Presenting Author: Simon Sidelnik
Co-authors: Mladen Nisavic, Theodore Stern

94. **Mitotane-induced Major Neurocognitive Disorder: A Case Report**

Presenting Author: Christopher Kogut
Co-author: Bushra Shah

95. **Neurologic and Psychiatric Impact of Immunotherapy and Chimeric Antigen Receptor (CAR) - T Cell Treatments**

Presenting Author: Mehak Sharma
Co-authors: Vasthie Prudent, Yesne Alici, William Breitbart

96. **Identifying and Addressing Anxiety in Cancer Patients**

Presenting Author: Sarah Parsons
Co-authors: Elizabeth Archer-Nanda, Marisa Crenshaw, Rebecca Reichert

97. **Progressive Multifocal Leukoencephalopathy After Autologous Stem Cell Transplantation: Considerations for a Patient with Bipolar Disorder**

Presenting Author: Aileen Park

98. **[T] Exploring Consultant Countertransference in the Terminal Ill Medical Provider: A Case Presentation**

Presenting Author: Sonia Riyaz

THURSDAY, NOV. 10

POSTER SESSION

THURSDAY, NOV. 10

99. **[T] Anxiety in the Head and Neck Cancer Patient: Prevalence, Correlations, and Management**

Presenting Author: Elise Stephenson
Co-authors: Eliza (Leeza) Park, Jordan Holmes

100. **Behavioral Health Oncology Consultation Service: Building an Integrative Hybrid Cancer Care Model to Meet the Growing Needs of the 21st Century Cancer Patient**

Presenting Author: Shannon Poppito

101. **Does Age Matter for Psychiatry Symptoms in Cancer Patients in an Outpatient Setting?**

Presenting Author: Jerry Ignatius

Section 11: Psychopharmacology & Toxicology

102. **Adverse Gastrointestinal Hypomotility Effects Associated with Clozapine: A Systematic Review**

Presenting Author: Mohsina Ahmed
Co-author: Katy LaLone

103. **[T] Delayed Onset Serotonin Syndrome with Psychotic Symptoms After Venlafaxine Overdose**

Presenting Author: Sabeen Haque
Co-authors: Rabiya Hasan, Natalia Ortiz

104. **[T] Management of Severe Pain and Bipolar Depression in a Patient with Osteogenesis Imperfecta**

Presenting Author: Shalini Dave
Co-author: Carolina Retamero

105. **Thoughtful Use of Thiamine Supplementation in the Medically Ill Patient**

Presenting Author: Michael Maksimowski
Co-author: Katy LaLone

106. **Antidepressant Use in Patients with Carcinoid Tumors: Results of a Systematic Review**

Presenting Author: Elie Isenberg-Grzeda
Co-authors: Meredith MacGregor, Konstantina Matsoukas, Diane Reidy-Lagunes, Yesne Alici

107. **[T] Thyroid Dysfunction and the Role of Exogenous T3 in Elderly Patients**

Presenting Author: Raja Mogallapu
Co-author: Trudie Somberg

108. **[T] Octreotide-associated Personality Changes in a 66-year-old Male**

Presenting Author: Jonathan Smith
Co-authors: Rick Carlson, Lesley Omary, Sheryl Fleisch

109. **[T] Manganese Madness: Role of Manganese in Hepatic Encephalopathy: A Case Report and Literature Review**

Presenting Author: Behdad Bozorgnia
Co-authors: Samidha Tripathi, Christian Kohler

110. **What's Your Awareness of Anesthesia Awareness?**

Presenting Author: Jennifer Brandstetter

111. **[T] Pneumonitis in Setting of High-dose Fluoxetine**

Presenting Author: Gabriel Fette
Co-author: James McConville

112. **[T] Sertraline and Diplopia: A Case Report**

Presenting Author: Adekola Alao

113. **[T] Potentiation of Parkinsonism with Mesalamine Administration**

Presenting Author: William Schleyer
Co-authors: Devendra Thakur, Coleman Dominiak, Christine Finn

114. **Pre-operative Quetiapine for Delirium Prophylaxis in a Patient with Parkinson's Disease Undergoing Deep Brain Stimulation Surgery**

Presenting Author: Sara Nash

115. **An Unusual Case of Serotonin Syndrome Related to Dialysis Modality and Clearance**

Presenting Author: Lara Feldman
Co-author: Jeffrey Lautman

116. **Recurrent Episodes of Transient Global Amnesia Related to Intrathecal Baclofen Pump: Originally Misdiagnosed as Non-epileptic Seizures**

Presenting Author: Paul Desan
Co-authors: Gulam Noorani, David Rosenblum

117. **A Case-based Systematic Review of Literature on Sleep-walking With and Without Sleep-related Eating in Association with Atypical Antipsychotic Therapy**

Presenting Author: Taru Dutt
Co-authors: Rahul Kashyap, Piyush Das

POSTER SESSION

118. **[T] Utility of Clozapine for Management of Agitation in Organic Brain Injury: A Case Report and Literature Review**

Presenting Author: Inder Kalra

Co-authors: Arpita Goswami Banerjee, Michael Marino

119. **[T] Ketamine-induced Mania on a Surgical Service**

Presenting Author: Nicholas Allen

Co-authors: Brian Rodysill, J. Michael Bostwick

120. **[T] Effects of Dextromethorphan/Quinidine in the Treatment of Post-brain Injury Aggression**

Presenting Author: Gabriel Heiber Bendayan

Co-author: R Lloyd

121. **[T] Psychiatry and Nail Salon Workers**

Presenting Author: Aos Mohammed Ameen

Co-authors: Houssam Raai, Jeffrey Levine

122. **[T] Ketamine Reversal of Psychogenic Coma: Case Report and Literature Review**

Presenting Author: Gregory Ross

Co-author: Ted Liao

123. **[T] Lithium Associated Takotsubo Cardiomyopathy in Bipolar Disorder: Case Analysis with Literature Review**

Presenting Author: Samantha Kennis

Co-authors: Carmen Casasnovas, Marla Shu, Seema Quraishi, Issa Bagayogo, Beatriz Cruz Alvarez

Section 12: Somatic Symptom Disorders

124. **[T] Psychometric Evaluation of Clinical Depression in Patients with Psychogenic Non-epileptic Seizures**

Presenting Author: Justin Shuster

Co-authors: Mamta Sapra, Lisa Faist

125. **A Retrospective Analysis of Psychosocial Variables in Patients with Confirmed or Highly Suspected Factitious Disorder**

Presenting Author: Ngozi Nkanginieme

Co-authors: Niyati Dhand, Karen Salerno, Xavier Jimenez

126. **[T] Can You Ever Correct a Misdiagnosis of Conversion?**

Presenting Author: Benjamin Braus

Co-authors: Elliot Handler, Robert Morgan, Teresa Rummans, Shirlene Sampson

127. Poster withdrawn

128. **[T] Improvement of Functional Neurological Spells with Successful Treatment of Associated Migraine**

Presenting Author: Leah Grengs

Co-author: Jeffrey Staab

129. **[T] Conflating Cryptogenic Deafness with Conversion: Meningoencephalitis in the Psychiatric Patient**

Presenting Author: Kristen Schmidt

Co-authors: Kemuel Philbrick, Joseph Kosmach, J. Michael Bostwick

Section 13: Special Topics

130. **Barriers to Health Behaviors in Heart Failure: The Reach for Health Study**

Presenting Author: Christopher Celano

Co-authors: Eleanor Beale, Elyse Park, Ana Villegas, Jeff Huffman

131. **[T] Baseline Depression Before Coronary Artery Bypass Graft Surgery and its Association with Intracranial Atherosclerosis: An Interim Analysis of the Neuropsychiatric Outcomes After Heart Surgery (NOAHS) Study**

Presenting Author: Mario Caro

Co-authors: Mark Oldham, Keith Hawkins, Ling Han, Leslie Scoutt, David Yuh, Hochang Lee

132. **[T] Left Ventricular Assist Device Placement: Evaluation Using a Comprehensive Protocol**

Presenting Author: Tanuja Gandhi

Co-author: Ajita Mathur

133. **[T] Psychiatric Comorbidities in Takotsubo (stress) Cardiomyopathy**

Presenting Author: Eric Rafla-Yuan

Co-author: Arash Nayeri

134. **[T] Nationwide Characterization of Patients with Suicide Attempts Treated with Hemodialysis, 2006-2013**

Presenting Author: Diana Robinson

Co-authors: David Hamilton, Joshua King, Priyanka Vakkalanka, Christopher Holstege

135. **[T] Stop Bugging My Itching Kidneys: Two Cases of Delusional Parasitosis in the Setting of End-stage Renal Disease**

Presenting Author: Ashley Ellison

Co-author: James McConville

THURSDAY, NOV. 10

SCHEDULE AND PROGRAM DETAILS

FRIDAY, NOV. 11

136. **[T] The Interplay Between Depression and Sleep Disorders in a Cross-sectional Sample of Patients on Maintenance Hemodialysis**

Presenting Author: Ammar El Sara

Co-authors: Stephanie Maung, Cherylle Chapman, Danielle Cohen, Daniel Cukor

137. **[T] Sins of Future Past: Development of Delusional Jealousy Following Liver Transplantation**

Presenting Author: Chase Warren

Co-authors: Renee Garcia, Yelizaveta Sher

138. **A Chameleon Strikes Again: Tacrolimus-induced Delayed Onset Atypical Neurotoxicity Manifesting as Major Depression**

Presenting Author: David Banayan

139. **Assessing Patients with Alcoholic Hepatitis for Early Liver Transplantation: Retrospective Review Using the Stanford Integrated Psychosocial Assessment for Transplant (SIPAT)**

Presenting Author: Akhil Shenoy

Co-authors: Zorica Filipovic, Kanwal Mohan, Aryeh Dienstag, Elizabeth Schubert, Mary Brosnan, Margot Wankoff, Laura Ford, Gene Im

Section 14: Substance Use & Related Disorders

140. **[T] Loperamide Abuse and Life-threatening Arrhythmias: What the Psychiatric Consultant Needs to Know**

Presenting Author: Mario Caro

Co-authors: Syed Amir Shah, George Tesar, Jason Jerry, Elias Khawam

141. **[T] A Case of Severe Withdrawal from Poppy Seed Tea**

Presenting Author: Rick Carlson

Co-authors: Jonathan Smith, Stephen Nicolson

142. **[T] 'But for Grace Go I': C-L Psychiatry's Role in Initial Impaired Physician Management**

Presenting Author: Jennifer Erickson

Co-authors: Carmen Casasnovas, Alan Yancovitch, Seema Quraishi, Joel Wallack, Kenneth Ashley, Daniel Safin

143. Poster withdrawn

144. **[T] A Tale of Two Roommates: Case Comparison of Alcohol Withdrawal Using Benzodiazepine-sparing Protocol**

Presenting Author: Renee Garcia

Co-authors: Jessica Gold, Amanda Franciscus, Jose Maldonado

145. **[T] Frozen in Time: Benzodiazepine Withdrawal Catatonia and What Psychosomatic Psychiatrists Should Know**

Presenting Author: Ottiniano Emily

Co-authors: Patricia Ordorica, Suad Kapetanovic, Dylan Whisenhunt

146. **Neuro-psychiatric Complication of Cannabis**

Presenting Author: Adekola Alao

Section 15: Training & Education

147. **[T] Chief Complaint: Poisoning**

Presenting Author: Bryce Winger

Co-author: Ted Liao

148. **[T] Psychoeducation of Non-psychiatric Residents: Comfort Level vs Educational Interest in Psychiatric Topics of Care**

Presenting Author: Abhisek Khandai

Co-authors: Adrienne Taylor, R Lloyd

149. **[T] Are Web-based Resources a Legitimate Form of Collateral Information for the Psychiatry Consult-Liaison Service?**

Presenting Author: Zehra Aftab

Co-authors: Kristina Thurin, Michael Marcangelo, Marie Tobin

150. **[T] SMART-R: Using Health Tracking Technology and Behavioral Intervention to Impact Resident Wellbeing**

Presenting Author: Deanna Chaukos

Co-authors: Emma Chad-Friedman, John Denninger

151. **Developing a Competency Framework for Medical Psychiatry Training in Undergraduate Medical Education**

Presenting Author: Sanjeev Sockalingam

Co-authors: Jana Lazor, Zarah Chaudhary, Kulamakan Kulasegaram, Maria Mylopoulos

152. **Research Domain Criteria (RDoC) Can Be a Neuroscientific Platform for Psychosomatics**

Presenting Author: James Strain

Co-author: Akhil Shenoy

SCHEDULE AND PROGRAM DETAILS

153. **Acute Stress Reactions in Internal Medicine Residents in the Post-code Setting**
Presenting Author: Stefanie Reiff
Co-authors: Sara Nash, Philip Muskin
154. **[T] Assessing Capacity: Helping Residents Navigate Through the Unsettling Fog**
Presenting Author: Erik Shwarts
Co-authors: Debra Kahn, Marcia Unger
155. **[T] Face the Music: Distinguishing Genuine from Feigned Auditory Hallucinations**
Presenting Author: Maria Anastasiades
Co-author: Ann Schwartz
156. **Appreciating and Differentiating Psychomotor Findings of Catatonia and Delirium: Educating Non-psychiatrists in Identification and Management**
Presenting Author: Daniel Fishman
Co-authors: Priya Gopalan, Pierre Azzam, David White
158. **Post-partum Obsessive-compulsive Disorder: Two Novel Cases Presenting with Neurologically-focused Obsessions**
Presenting Author: Rachel Shmuts
Co-author: Deborah Kim
159. **[T] Reducing Missed Appointments in a Perinatal Psychiatric Consultation Clinic**
Presenting Author: Jessica Molinaro
Co-author: Christina Wichman
160. **[T] Intentional Overdose in Pregnancy: Clinical Features and Management of Toxidromes**
Presenting Author: Neeta Shenai
Co-authors: Erin Smith, Priya Gopalan, Pierre Azzam, Jody Glance
161. **Treatment of Premenstrual Breakthrough of Depression with Adjunctive Oral Contraceptive Pills Compared to Placebo**
Presenting Author: Whitney Peters
Co-authors: Marlene Freeman, Semmie Kim, Lee Cohen, Hadine Joffe

Section 16: Women's Mental Health

157. **[T] Universal Screening for Postpartum Depression in the NICU: A Survey-based Study of Nurses' Attitudes**
Presenting Author: Jessie Rice
Co-authors: Amritha Bhat, Deborah Cowley

FRIDAY, NOV. 11

FRIDAY, NOV. 11

6:00 – 6:45 AM	Neighborhood Run	Meet in hotel lobby
6:30 AM – 6:00 PM	Registration Desk open	Griffin Hall
7:00 – 7:45 AM	Mindfulness Meditation with Paul Jones, MD	504
7:00 – 7:45 AM	APM Committee Meetings APM committee members only	See page 47
7:45 – 8:30 AM	APM Special Interest Group meetings Open to everyone; APM membership not required	See page 47
7:45 – 8:30 AM	All About APM Membership Non-members are invited to a breakfast meeting with APM leaders to learn more about the value and professional connections available through Academy membership, and how to join.	407
8:30 AM – 5:00 PM	Exhibits open	JW Grand Ballroom Foyer

SCHEDULE AND PROGRAM DETAILS

8:30 – 8:45 AM	Light refreshments	JW Grand Ballroom Foyer
8:45 – 9:00 AM	Announcements Awards for: Best Poster, Best Trainee Poster, Best Case Report Poster	JW Grand Ballroom 5/6
9:00 – 9:45 AM	President's Symposium Part 2: Pathophysiology of Functional Movement Disorders [0.75 CME] Introduction by: Steve Epstein, MD, FAPM , APM President	JW Grand Ballroom 5/6
	 Mark Hallett, MD Chief, Human Motor Control Section, National Institute of Neurological Disorders and Stroke, NIH, Bethesda, MD	
9:45 – 10:00 AM	Break	

10:15 – 11:45 AM **5 Concurrent Oral Paper Sections [1.5 CME]**

Section A: Cardiology JW Grand Ballroom 2

Moderator/Discussant: **Terry Schneekloth, MD, FAPM**

Gender Differences in Depression and Anxiety with Cardiac Procedures

Presenting Author: Vani Ray
Co-authors: V.S. Murthy, Shraddha Nayak, Abhilasha Ghildyal, Traci Hempler

Perioperative Transcranial Doppler as a Predictor for Post-cardiotomy Delirium: Results from the Neuropsychiatric Outcomes After Heart Surgery (NOAHS) Study

Presenting Author: Mark Oldham
Co-authors: Keith Hawkins, Ling Han, Leslie Scoutt, David Yuh, Hochang Lee

The Impact of Sleep Duration and Quality on Left Ventricle

Presenting Author: Jae-Hon Lee
Co-authors: Sung Keun Park, Rodrigo Mansur, Jeffrey Alfonsi, Yena Lee, Roger McIntyre, Ju Young Jung

When a Cardiologist Joins Integrated Care in a Day Treatment Program: The Comprehensive Cardiovascular Prevention Program

Presenting Author: Ellen Coffey
Co-author: Woubeshet Ayenew

Section B: Neuropsychiatry JW Grand Ballroom 3

Moderator/Discussant: **Mary Jo Fitz-Gerald, MD, FAPM**

Collaborative Care for Pain and Depression in Patients with Spinal Cord Injury and Multiple Sclerosis: The SCI-CARE and MS-CARE Randomized Controlled Trials

Presenting Author: Jesse Fann
Co-authors: Charles Bombardier, Dawn Ehde, Maria Reyes, Kevin Alschuler, Mark Sullivan

Delayed Neuropsychiatric Syndrome Following Carbon Monoxide Poisoning: Case Presentation and Literature Review

Presenting Author: Liliya Gershengoren

Polysomnographic Findings in Fibromyalgia: A Retrospective Chart Review

Presenting Author: Edwin Meresh
Co-authors: Abraham Ghattas, Murali Rao, Aparna Sharma, Angelos Halaris

FRIDAY, NOV. 11

SCHEDULE AND PROGRAM DETAILS

Section C: Psycho-oncology Part I

JW Grand Ballroom 4

Moderator/Discussant: **Bradford Bobrin, MD, FAPM**

Experts' Perspectives on the Role of Medical Marijuana in Oncology: A Semi-structured Interview Study

Presenting Author: Ilana Braun

Co-authors: Joshua Gagne, Manan Nayak

Mothers with Metastatic Cancer: Factors Associated with Depression, Anxiety, and Quality of Life

Presenting Author: Eliza (Leeza) Park

Co-authors: Allison Deal, Justin Yopp, Claire Hailey, Zev Nakamura, Samuel Resnick, Donald Rosenstein

Predictors of Disruptions in Breast Cancer Care for Individuals with Schizophrenia

Presenting Author: Kelly Irwin

Co-authors: Elyse Park, William Pirl, Lauren Fields

Retrospective Chart Review of Antidepressant Use in Patients with Carcinoid Tumors

Presenting Author: Elie Isenberg-Grzeda

Co-authors: Meredith MacGregor, Afton Bergel, Stacy Eagle, Fernando Espi Forcen, Reema Mehta, Konstantina Matsoukas, Jonathan Wills, Yesne Alici, Diane Reidy-Lagunes

Section D: Suicide

402/403

Moderator/Discussant: **Rita Hargrave, MD**

Feasibility of Screening for Suicide Risk on a Pediatric Inpatient Medical/Surgical Unit

Presenting Author: Lisa Horowitz

Co-authors: Daniel Powell, Martine Solages, Jeff Bridge, Abigail Ross, Erina White, Jarrod Smith, Maryland Pao, Elizabeth Wharff

Identification of Suicidal Patients with Machine Learning Recognition of Auditory and Linguistic Characteristics

Presenting Author: Cheryl McCullumsmith

Co-authors: Brian Connolly, John Pestian

Increased Suicide Risk in Pediatric Endocrine and Diabetes Patients

Presenting Author: Shayla Sullivant

Co-authors: Kathy Goggin, Andrea Bradley-Ewing, Sabra Boyd, Lisa Horowitz, Elizabeth Wharff, Daniel Powell, Sharee Smallwood, Kristen Williams, Maryland Pao

Stimulus to Swallow: A Multivariable Analysis of Patients with Deliberate Foreign Body Ingestion

Presenting Author: Niyati Dhand

Co-authors: Karen Salerno, Ngozi Nkanginieme, Xavier Jimenez

Section E: Women's Mental Health

211/212

Moderator/Discussant: **Dahlia Saad Pendergrass, MD**

Are SSRIs Associated with Congenital Malformations? A Meta-Analysis in a Psychiatric Population

Presenting Author: Katherine Blackwell

Co-authors: Melissa Cranford, Catherine Coughlin, Magdalena Reyes, Michael Bloch

Physicians' Perceived Roles and Barriers in Caring for Female Sexual Assault Survivors: A Qualitative Study

Presenting Author: Priyanka Amin

Co-authors: Judy Chang, Raquel Buranosky

Program in Support of Moms (PRISM)

Presenting Author: Nancy Byatt

Co-authors: Tiffany Moore Simas, Kathleen Biebel, Linda Weinreb, Lori Pbert, Douglas Ziedonis, Jeroan Allison



WEBB FELLOW: Delivering Perinatal Depression Care in a Rural Obstetric Setting: A Pilot Study

Presenting Author: Amritha Bhat

Co-authors: Johnny Mao, Mindy Vredevoogd, Roger Rowles, Susan Reed, Jürgen Ünitzer

FRIDAY, NOV. 11

SCHEDULE AND PROGRAM DETAILS

10:15 – 11:45 AM

4 Concurrent General Sessions [1.5 CME]

GS29 Co-managing the Same Brain: Psychiatry and Neurology Working Together in the Care of Patients with Complex Neuropsychiatric Syndromes

201/202

BCN

Carrie Ernst, MD, Icahn School of Medicine at Mount Sinai, New York, NY

Suneina Mohan, MD, FRCPC, Cumming School of Medicine, University of Calgary, Calgary, AB, Canada

Akhil Shenoy, MD, Icahn School of Medicine at Mount Sinai, New York, NY

Lara Marcuse, MD, Icahn School of Medicine at Mount Sinai, New York, NY

Madeline Fields, MD, Icahn School of Medicine at Mount Sinai, New York, NY

GS30 As Clear as Mud: Ethical Dilemmas in Transplant Psychiatry

203/204

ETH

Amy Christianson, MD, Cedars-Sinai Medical Center, Los Angeles, CA

Yelizaveta Sher, MD, Stanford University, Stanford, CA

Cathy Crone, MD, FAPM, George Washington University Medical Center, Falls Church, VA

Renee Garcia, MD, Stanford University Medical Center, Stanford, CA

Jose Maldonado, MD, FAPM, FAFCE, Stanford University, Stanford, CA

GS31 ADHD Boot Camp for Collaborative Care Providers: Neurobiology, Diagnosis, Treatment, and Model Systems of Care for Patients of All Ages

JW Grand Ballroom 1

ITC

Chelsea Ale, PhD, Mayo Clinic Health System, La Crosse, WI

Kristin Somers, MD, FAPM, Mayo Clinic, Rochester, MN

Alastair McKean, MD, Mayo Clinic, Rochester, MN

Sandra Rackley, MD, FAPM, Mayo Clinic, Rochester, MN

Special Invited Symposium: Neuropsychiatric Manifestations of Infectious Disease Across the Lifespan: Lyme Disease and PANDAS

Brazos

Introduction by: **Jeff Huffman, MD, FAPM**

PANDAS: Are Contamination Fears Justified in Childhood-onset Obsessive Compulsive Disorder?

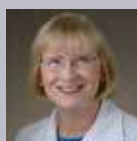

Susan Swedo, MD

Chief, Pediatrics & Developmental Neuroscience Branch, National Institute of Mental Health, Bethesda, MD

The Manifestations, Assessment, and Treatment of Neuropsychiatric Lyme Disease



Brian Fallon, MD

Director, Lyme & Tick-borne Diseases Research Center & Center for Neuroinflammatory Disorders & Biobehavioral Medicine, NYS Psychiatric Institute & Columbia University Medical Center, New York, NY

FRIDAY, NOV. 11

Program Tracks

ADP	ADM	BCN	CDE	EDT	ETH
Addictions and Pain	Administration	Basic & Clinical Neuroscience	Career Development & ECP	Education & Training	Ethics, Oncology, and End-of-Life Care
ITC	MSP	NEP	POT	PLI	WMH
Integrated Care	Medical Specialties	Neuropsychiatry	Potpourri	Psychotherapy & Liaison Interventions	Women's Mental Health

APM 2016 AWARDS

12:00 – 1:00 PM

Awards/Fellowship Lunch

JW Grand Ballroom 5/6

Hosted SIG tables: APM SIG representatives will be hosting discussion tables during lunch, at which they will discuss the work of their SIGs, plans for the future, and how YOU can play a part. SIG tables are open to anyone attending the meeting and are first-come, first-served. Each SIG table will be sign-posted; seating is first-come, first served.

Eleanor and Thomas P. Hackett Memorial Award



Donald Rosenstein, MD, FAPM

University of North Carolina, Chapel Hill, NC

William L. Webb Fellowship

Presented by: **E. Sherwood Brown, MD, PhD, FAPM**



Katherine Blackwell, MD, PhD

Institute of Living, Hartford, CT



Mario Caro, MD

Yale New Haven Hospital, New Haven, CT



Deanna Chaukos, MD

Massachusetts General Hospital, Boston, MA



Jennifer Erickson, DO

Mount Sinai Beth Israel, New York, NY



Neeta Shenai, MD

Western Psychiatric Institute and Clinic of UPMC, Pittsburgh, PA



Nathaniel Sowa, MD, PhD

University of Washington, Seattle, WA

Wayne Katon Research Award



Matthew Hotopf, MRCPsych, PhD

King's College London, Denmark Hill, United Kingdom

Alan Stoudemire Award for Innovation & Excellence in Psychosomatic Medicine Education

Presented by: **Hochang Benjamin Lee, MD, FAPM**



Integrated Care Pathway: Psychiatry in Medical Settings, at the University of Washington, Seattle, WA

Program Director: **Anna Ratzliff, MD, PhD**

FRIDAY, NOV. 11

APM 2016 AWARDS

Visiting PM/C-L Professor Awards

Presented by: **Hochang Benjamin Lee, MD, FAPM**



Nancy Byatt, DO, FAPM, visiting University of Washington School of Medicine
Nominated by: Joseph Cerimele, MD



Sanjeev Sockalingam, MD, FAPA, FAPM, visiting Thomas Jefferson University
Nominated by: Omair Abbasi, MD



Jürgen Unützer, MD, visiting University of Southern California LAC+USC Medical Center
Nominated by: Isabel Lagomasino, MD, FAPM

Dlin/Fischer Clinical Research Award



Jesse Fann, MD, FAPM
University of Washington, Seattle, WA

Dorfman Journal Paper Awards

For the best papers published in the Academy's journal, *Psychosomatics*
Presented by: **Theodore Stern, MD, FAPM**

Best Case Report:

Service Dogs in the Hospital: Helpful or Harmful? A Case Report and Clinical Recommendations, by Laurel Pellegrino, MD; Joseph Cerimele, MD; and Amelia Dubovsky, MD.

Best Article for Original Research:

Toronto Bariatric Interprofessional Psychosocial Assessment Suitability Scale: Evaluating A New Clinical Assessment Tool for Bariatric Surgery Candidates, by Gurmeet Thiara, MD; Richard Yanofsky, MD, FRCPC; Sayed Abdul-Kader, MD, FRCPC; Vincent Santiago, BSc; Stephanie Cassin, PhD, CPsych; Allan Okrainec, MD, FRCSC; Timothy Jackson, MD, FRCSC; Raed Hawa, MD, FRCPC; and Sanjeev Sockalingam, MD, FRCPC, FAPM.

Best Review Article:

Guidelines for the Management of Pregnant Women with Substance Use Disorders, by Laura McLafferty, MD; Madeleine Becker, MD, FAPM; Nehama Dresner, MD, FAPM; Samantha Meltzer-Brody, MD; Priya Gopalan, MD; Jody Glance, MD; Guitelle St. Victor, MD, FAPM; Leena Mittal, MD, FAPM; Patrick Marshalek, MD; Laura Lander, LCSW; and Linda Worley, MD, FAPM.

Don R. Lipsitt Award for Achievement in Integrated and Collaborative Care



Jürgen Unützer, MD
University of Washington School of Medicine, Seattle, WA

2016 APM Fellows

Presented by: **Steve Epstein, MD, FAPM**

Wendy Baer, MD
Brian Bronson, MD
Daniel Elswick, MD

Steven Frankel, MD
Dwayne Heitmiller, MD
Jeanne Lackamp, MD

Laura Markley, MD
Beena Nair, MD
Thomas Penders, MD

FRIDAY, NOV. 11

APM 2016 AWARDS

Early Career Researcher Mentorship Program

Presented by: **Michael Sharpe, MD, FAPM**



Research Professor Award

Kurt Kroenke, MD,
Indiana University School of Medicine,
Indianapolis, IN



Hsiang Huang, MD

Cambridge Health Alliance, Boston, MA



Joseph Cerimele, MD

University of Washington School of
Medicine, Seattle, WA



Mark Oldham, MD

Yale School of Medicine, New Haven, CT

Trainee Travel Awards

Jose Arriola Vigo, MD,

Vanderbilt University Medical Center

Subani Maheshwari, MD,

Einstein Medical Center

Joan Roig Llesuy, MD,

University of Chicago

Larkin Elderon, MD,

Boston University Medical Center

Deepa Pawar, MD,

Medical College of Wisconsin

Simon Sidelnik, MD,

Massachusetts General Hospital

Abraham Ghattas, DO,

Loyola University Medical Center

Whitney Peters, MD,

Brigham and Women's Hospital

Jonathan Smith, MD,

Vanderbilt University

Arpita Goswami Banerjee, MD,

University of Pennsylvania

Laura Poellet, MD, JD,

Vanderbilt University Medical Center

Thida Thant, MD,

University of Colorado

Hermioni Lokko, MD,

Brigham and Women's Hospital

Diana Robinson, MD,

University of Virginia

Robin Valpey, MD,

Western Psychiatric Institute and
Clinic of UPMC

With thanks to the Foundation of the Academy of Psychosomatic Medicine for its support to the William L. Webb Fellowship, Don R. Lipsitt Award and Trainee Travel Awards.

1:00 – 1:45 PM

Eleanor and Thomas P. Hackett Memorial Award [0.75 CME]

JW Grand Ballroom 5/6

Introduction by: **Maryland Pao, MD, FAPM**

In the Middle of Where Everything is Missing



Donald Rosenstein, MD, FAPM

Director, Cancer Support, University of North Carolina, Chapel Hill, NC

1:45 – 2:00 PM

Break

FRIDAY, NOV. 11

SCHEDULE AND PROGRAM DETAILS

2:00 – 3:30 PM

6 Concurrent Oral Paper Sections [1.5 CME]

Section F: Behavioral Interventions

JW Grand Ballroom 1

Moderator/Discussant: **Laura Kent, MD, FAPM**

A Matched Comparison Study of Medical and Psychiatric Complications in Methadone-Maintained Liver Transplant Recipients: A 20-year Perspective

Presenting Author: Robert Weinrieb

Co-authors: Omair Abbasi, Alexandra Leto, Kevin Lynch, George Makar

Pre-Operative Opioid Reduction: An Integrative Approach

Presenting Author: Margaret Haglund

Co-authors: Sameer Hassamal, Karl Wittnebel, Itai Danovitch

Pre-surgical Problematic Eating Behaviors Predict Outcomes After Bariatric Surgery

Presenting Author: Lisa Miller-Matero

Co-authors: Caroline Saulino, Kate Dykhuis, Kelly Bryce, Arthur Carlin, Jeffrey Genaw

WEBB FELLOW: StreetChange: The Ethics of Motivating Behavior Change Using Incentives



Presenting Author: Andrew Siegel

Section G: Delirium

JW Grand Ballroom 2

Moderator/Discussant: **Thomas Heinrich, MD, FAPM**

Agitation, Delirium and Cognitive Outcomes in Intracerebral Hemorrhage

Presenting Author: Lisa Rosenthal

Co-authors: Brandon Francis, Jennifer Beaumont, David Cella, Matthew Maas, Eric Liotta, Robert Askew, Andrew Naidech, Michael Berman

Cardiac Surgery Patients and Assessment of Risk for Delirium

Presenting Author: Rima Styra

Co-author: Elisabeth Larsen

Delirium After Lung Transplantation: Associations with Morbidity, Mortality, and Resource Use

Presenting Author: Yelizaveta Sher

Co-authors: Joshua Mooney, Gundeep Dhillon, Jose Maldonado

WEBB FELLOW: A Data Driven Approach to Identification of Deliriogenic Medications



Presenting Author: Thomas McCoy

Section H: Inpatient Topics

JW Grand Ballroom 3

Moderator/Discussant: **Janna Gordon-Elliott, MD, FAPM**

Association of Limited English Proficiency with Rate of Psychiatric Consultation in a General Hospital

Presenting Author: Adrienne Mishkin

Co-authors: Stephanie Cheung, Peter Shapiro

Psychiatric Conditions Among Medical Inpatients with Central Line Associated Blood Stream Infections: Opportunities to Improve Patient Care and to Assist Hospital Patient Safety Efforts

Presenting Author: Avram Mack

Co-authors: Erin Brooks, Ashley Sharp

Psychotropic Medication Side Effects Consultation Service

Presenting Author: Terry Rabinowitz

Co-authors: Clayton English, A Evan Eyler

WEBB FELLOW: Predictors of ECT Use in a Large Inpatient Psychiatric Population



Presenting Author: Julia Knight

Co-authors: John Hirdes, A Evan Eyler, Terry Rabinowitz

FRIDAY, NOV. 11

SCHEDULE AND PROGRAM DETAILS

Section I: Psycho-oncology Part II

JW Grand Ballroom 4

Moderator/Discussant: **Bradford Bobrin, MD, FAPM**

A Model for Collaborative Spiritual and Psychiatric Care of Oncology Patients

Presenting Author: Larkin Elderon

Co-authors: Kathleen Gallivan, Vera O'Brien, John Peteet

Association Between Oncologist' Burn out and Depressive Symptoms in Their Patients with Incurable Cancers

Presenting Author: William Pirl

Co-authors: Jennifer Lerner, Lara Traeger, Justin Eusebio, Lauren Fields, Areej El-Jawahri, Joseph Greer, Jennifer Temel

Exploring the Role of Psycho-oncology in the Rural and Satellite Oncology Clinics: Results of Needs Assessment Survey

Presenting Author: Robin Valpey

Co-authors: Kevin Patterson, Priya Gopalan, Pierre Azzam

Glioblastoma Multiforme and Brittany Maynard's Choice

Presenting Author: Lewis Cohen

Section J: Telepsychiatry

402/403

Moderator/Discussant: **Donald Hilty, MD**

Dlin/Fischer Award Lecture: Impact of a Telehealth Intervention on Common Comorbid Conditions of Mild Traumatic Brain Injury in Active Duty Service Members: A Randomized Controlled Trial

Introduction by: **Michael Sharpe, MD, FAPM**



Presenting Author: **Jesse Fann, MD, FAPM**, Professor, University of Washington, Seattle, WA

Co-authors: Kathleen Bell, Jo Ann Brockway, Wesley Cole, Nancy Temkin

Psychiatric Consultation for Medical and Surgical Inpatient Services via Telepsychiatry

Presenting Author: Julie Graziane

Co-author: Jack Cahalane

Telepsychiatry for a Primary Care, Urban, Safety Net Health System: Benefits for Underserved Patients and Providers Who Care for Them

Presenting Author: Robert Joseph

Co-authors: Hsiang Huang, Carrie Cunningham

Section K: Training & Education

211/212

Moderator/Discussant: **Mary Jo Fitz-Gerald, MD, FAPM**

My Story: How We as Providers Should Aspire for a Better Healthcare System

Presenting Author: Karthik Sivashanker

Co-authors: Alana Bunnag, Stephan Gaehde, Grace Chang

Medical Student Experiences on Consultation-Liaison Psychiatry Rotations: A Nationwide Survey

Presenting Author: Fremonta Meyer

Co-authors: Omair Abbasi, David Kasick, Kewchang Lee, Christine Pelic, Jennifer Zinser, Thomas Harris, Margo Funk

Towards a New Narrative Medicine Workshop: Using Nonfiction Writing Workshops to Foster Intersubjectivity Between Patients and Physicians-in-Training

Presenting Author: Jonathan Chou

Co-authors: Ianthe Schepel, Pamela Schaff, Suad Kapetanovic

FRIDAY, NOV. 11

SCHEDULE AND PROGRAM DETAILS

FRIDAY, NOV. 11

2:00 – 3:30 PM

3 Concurrent General Sessions [1.5 CME]

GS32 Cracking the Code: An Interactive Coding Workshop

203/204

ADM

Curtis McKnight, MD, Creighton University School of Medicine, Phoenix, AZ
Sarah Parsons, DO, Norton Cancer Institute, Louisville, KY
Junji Takeshita, MD, John A. Burns School of Medicine, University of Hawaii, Honolulu, HI
Steven Fischel, MD, PhD, FAPM, DFAPA, Tufts University School of Medicine, Springfield, MA
James Kimball, MD, Wake Forest Univ Baptist Med Ctr, Advance, NC

GS34 Neuroethics of Decision Making Capacity Determinations: Improving Our Dimensional Depth Perception Across the Life Span – A Collaborative Bioethics and Pediatric Psychosomatic Medicine SIGs Symposium

Brazos

ETH

Talin Dadoyan, MD, FAPM, University of California UCLA, Sherman Oaks, CA
J.J. Rasimas, MD, PhD, FAPM, Hennepin County Medical Center, Minneapolis, MN
Mary Lynn Dell, MD, DMin, FAPM, DFAACAP, The Ohio State University, Dublin, OH
J. Michael Bostwick, MD, FAPM, Mayo Clinic, Rochester, MN

GS33 Careers in Psychosomatic Medicine [TRAINEES ONLY]

201/202

CDE

Carrie Ernst, MD, Icahn School of Medicine at Mount Sinai, New York, NY
Scott Beach, MD, FAPM, Massachusetts General Hospital, Boston, MA
Jeanne Lackamp, MD, FAPA, University Hospitals Cleveland Medical Center, Cleveland, OH
John Wells, MD, Louisiana State University Health Sciences Center, New Orleans, LA
Paula Zimbrea, MD, FAPM, FAPA, Yale University, New Haven, CT
Sheryl Fleisch, MD, Vanderbilt University Medical Center, Nashville, TN
Kristin Somers, MD, FAPM, Mayo Clinic, Rochester, MN

3:30 – 3:45 PM

Break

Program Tracks					
ADP	ADM	BCN	CDE	EDT	ETH
Addictions and Pain	Administration	Basic & Clinical Neuroscience	Career Development & ECP	Education & Training	Ethics, Oncology, and End-of-Life Care
ITC	MSP	NEP	POT	PLI	WMH
Integrated Care	Medical Specialties	Neuropsychiatry	Potpourri	Psychotherapy & Liaison Interventions	Women's Mental Health

SCHEDULE AND PROGRAM DETAILS

3:45 – 5:15 PM

9 Concurrent General Sessions [1.5 CME]

**GS35 Substance Abuse in Women:
From Preconception to Postpartum
Care**

203/204

ADP

Carrie Ernst, MD, Icahn School of Medicine at Mount Sinai, New York, NY

Kimberly Yonkers, MD, Yale School of Medicine, Redding, CT

Ariadna Forray, MD, Yale School of Medicine, New Haven, CT

Madeleine Becker, MD, FAPM, Thomas Jefferson University Hospital, Philadelphia, PA

Nehama Dresner, MD, FAPM, Northwestern University Feinberg School of Medicine, Chicago, IL

Leena Mittal, MD, FAPM, Harvard Medical School, Boston, MA

**GS36 Neurobiology of Extrapyr-
amidal Symptoms**

211/212

CDE

Fernando Espi Forcen, MD, PhD, Rush University Medical Center, Chicago, IL

Juan Jaramillo, MD, University of Tennessee, Memphis, Memphis, TN

Kirk Harris, MD, Rush University Medical Center, Chicago, IL

David Banayan, MD, FRCPC, Rush University Medical Center, Chicago, IL

**GS37 Incorporating Neuroscience
Education into Trainee Experiences in
Consultation-Liaison Psychiatry**

201/202

EDT

Pierre Azzam, MD, FAPM, Western Psychiatric Institute and Clinic of UPMC, Pittsburgh, PA

Priya Gopalan, MD, Western Psychiatric Institute and Clinic of UPMC, Pittsburgh, PA

Robin Valpey, MD, Western Psychiatric Institute and Clinic of UPMC, Pittsburgh, PA

Neeta Shenai, MD, University of Pittsburgh Medical Center, Pittsburgh, PA

Patrick Aquino, MD, FAPM, Lahey Hospital & Medical Center, Burlington, MA

Darcy Moschenross, MD, PhD, Western Psychiatric Institute and Clinic of UPMC, Pittsburgh, PA

**GS38 Chemotherapy-related
Cognitive Dysfunction (Chemobrain):
Recognition, Biological Mechanisms,
and Management**

JW Grand
Ballroom 1

ETH

Fremonta Meyer, MD, FAPM, Brigham and Women's/Dana-Farber Cancer Center, Boston, MA

Carlos Fernandez-Robles, MD, Massachusetts General Hospital, Cambridge, MA

Hermioni Lokko, MD, Brigham and Women's Hospital/Dana-Farber Cancer Institute, Boston, MA

Kaleena Chilcote, MD, Western Psychiatric Institute and Clinic of UPMC, Pittsburgh, PA

Beatriz Currier, MD, FAPM, Miami Cancer Institute at Baptist Health South Florida, Miami, FL

**GS39 Dissemination of Evidence-
Based Integrated Care: The
Collaborative Care Model**

JW Grand
Ballroom 2

ITC

David Gitlin, MD, FAPM, DFAPA, Brigham and Women's Hospital, Boston, MA

Anita Everett, MD, DFAPA, Johns Hopkins School of Medicine, Glenwood, MD

Carol Alter, MD, FAPM, Mindoula Health, Bethesda, MD

James Rundell, MD, FAPM, Uniformed Services University of the Health Sciences School of Medicine, Bethesda, MD

Marc Avery, MD, University of Washington, Seattle, WA

Mark Williams, MD, Mayo Clinic, Rochester, MN

David Liu, MD, University of California, Davis, Sacramento, CA

**GS40 Excited Delirium Syndrome:
What Every C-L Psychiatrist Needs to
Know**

JW Grand
Ballroom 3

NEP

Lex Denysenko, MD, FAPM, Rowan University SOM, Cherry Hill, NJ

Thomas Penders, MD, DLFAPA, Brody School of Medicine, East Carolina University, Washington, NC

Michael Jones, MD, FAAEM, Albert Einstein / Jacobi and Montefiore Medical Centers, New York, NY

J.J. Rasimas, MD, PhD, FAPM, Hennepin County Medical Center, Minneapolis, MN

FRIDAY, NOV. 11

SCHEDULE AND PROGRAM DETAILS

FRIDAY, NOV. 11

Program Tracks			
ADP	ADM	BCN	CDE
Addictions and Pain	Administration	Basic & Clinical Neuroscience	Career Development & ECP
EDT	ETH	ITC	MSP
Education & Training	Ethics, Oncology, and End-of-Life Care	Integrated Care	Medical Specialties
NEP	POT	PLI	WMH
Neuropsychiatry	Potpourri	Psychotherapy & Liaison Interventions	Women's Mental Health

GS41 Mind-body Medicine for the PM Provider: From Body to Brain, from Breath to Bedside JW Grand Ballroom 4 **PLI**

Janna Gordon-Elliott, MD, FAPM, NewYork-Presbyterian/Weill Cornell Medical Center, New York, NY
Susan Evans, PhD, Weill Cornell Medical College, New York, NY
Jessica Daniels, MD, NewYork-Presbyterian/Weill Cornell Medical Center, New York, NY
Philip Muskin, MD, FAPM, Columbia University, New York, NY
Neala Rafizadeh, MD, Columbia University Medical Center, New York, NY

GS42 Complex Ethical and Psychiatric Issues of Maternal Death: Collaborative Symposium from the Pediatric and Bioethics SIGs 402/403 **WMH**

Susan Turkel, MD, FAPM, Children's Hospital Los Angeles USC, Los Angeles, CA
Eliza (Leeza) Park, MD, FAPM, University of North Carolina at Chapel Hill, Chapel Hill, NC
Henry Weisman, MD, FAPM, Texas Tech University Health Sciences Center El Paso, El Paso, TX
Victor Stiebel, MD, FAPM, University of Pittsburgh Medical Center, Pittsburgh, PA
Anna Muriel, MD, Dana-Farber Cancer Institute, Boston, MA

RES2 Research for Researchers 211/212

Kurt Kroenke, MD, Indiana University School of Medicine, Indianapolis, IN
Jeff Huffman, MD, FAPM, Massachusetts General Hospital, Boston, MA
Michael Sharpe, MD, FAPM, University of Oxford, Oxford, United Kingdom

5:30 PM	Exhibits breakdown	JW Grand Ballroom Foyer
5:30 – 6:30 PM	Medical Student & Resident Meet-&-Greet	213
	Join the APM Medical Student Education Subcommittee in welcoming medical students and resident to the annual meeting! This meet-and-greet is open to all medical students and residents wanting to learn more about psychosomatic medicine or training in psychiatry. We welcome any residents, fellows, program directors or other APM members interested in mentorship or recruitment of students into our exciting field.	
5:30 – 6:30 PM	Webb Fellows Reception	Per invitation

SCHEDULE AND PROGRAM DETAILS



SATURDAY, NOV. 12

6:30 AM – 6:00 PM	Registration Desk open	Griffin Hall
7:00 – 7:45 AM	Mindfulness Meditation with Paul Jones, MD	504
7:00 – 7:45 AM	APM Special Interest Group meetings Open to everyone; APM membership not required	See page 47
7:45 – 8:30 AM	APM Committee Meetings APM committee members only	See page 47
8:30 – 8:45 AM	Light refreshments	JW Grand Ballroom 5/6
8:45 – 9:00 AM	Announcements	JW Grand Ballroom 5/6
9:00 – 9:45 AM	Controversial Clinical Management Scenarios in Psychosomatic Medicine: A Debate [0.75 CME] Moderator/Discussant: <ul style="list-style-type: none"> • Christina Wichman, DO, FAPM, Medical College of Wisconsin, Muskego, WI Invited speakers:  Theodore Stern, MD, FAPM Massachusetts General Hospital/Harvard Medical School, Boston, MA  Jose Maldonado, MD, FAPM, FACFE Stanford University, Stanford, CA	JW Grand Ballroom 5/6
9:45 – 10:15 AM	Break	

SATURDAY, NOV. 12

SCHEDULE AND PROGRAM DETAILS

10:15 – 11:45 AM

9 Concurrent General Sessions [1.5 CME]

GS43 Substance Use Challenges in the General Hospital: Death and Legal Issues

408/409

ADP

Sheryl Fleisch, MD, Vanderbilt University Medical Center, Nashville, TN

Jonathan Smith, MD, Vanderbilt University Medical Center, Nashville, TN

Laura Poellet, MD, JD, Vanderbilt University Medical Center, Nashville, TN

Stephen Nicolson, MD, FAPM, Beth Israel Deaconess Hospital, Plymouth, Plymouth, MA

GS44 Co-managed Inpatient Care: There Is More Than One Way to Skin a Cat: Case Presentation and Consultative Workshop for Med-Psych Inpatient Care

402/403

ADM

Philip Muskin, MD, FAPM, Columbia University, New York, NY

Gen Shinozaki, MD, FAPM, University of Iowa, Department of Psychiatry, Iowa City, IA

Ellen Coffey, MD, FACP, Hennepin County Medical Center, Minneapolis, MN

David Hilden, MD FACP, Hennepin County Medical Center, Minneapolis, MN

Christopher Burke, MD, FAPM, Long Island Jewish Medical Center, New York, NY

Diego Coira, MD, FAPA, Hackensack University Medical Center, Hackensack, NJ

Aubrey Chan, MD, PhD, University of Iowa Hospitals and Clinics, Coralville, IA

GS45 Psychiatric Symptom Management and ‘Aggressive’ Care in Advanced and Terminal Neuropsychiatric Illness: Strategies and Barriers

Brazos

BCN

Christopher Martin, MD, Penn State Milton S. Hershey Medical Center, Harrisburg, PA

Laura McLafferty, MD, Crozer-Keystone Health System, Marlton, NJ

Pierre Azzam, MD, FAPM, Western Psychiatric Institute and Clinic of UPMC, Pittsburgh, PA

Priya Gopalan, MD, Western Psychiatric Institute and Clinic of UPMC, Pittsburgh, PA

Roshni Guerry, MD, Christiana Care Health System, Newark, DE

Morgan Faeder, MD, PhD, Western Psychiatric Institute and Clinic of UPMC, Pittsburgh, PA

GS46 Physician Burnout – A Looming Crisis

JW Grand Ballroom 1

CDE

Michael Peterson, MD, PhD, FAPM, University of Wisconsin, Madison, Madison, WI

Thomas Heinrich, MD, FAPM, Medical College of Wisconsin, Milwaukee, WI

Wendy Baer, MD, Emory University, Atlanta, GA

Ann Schwartz, MD, FAPM, Emory University School of Medicine, Atlanta, GA

GS47 Role of the Psychosomatic Medicine Psychiatrist in Teaching Integrated Care to Trainees Across the Spectrum

JW Grand Ballroom 2

EDT

Anna Ratzliff, MD, PhD, University of Washington, Seattle, WA

Jürgen Unützer, MD, University of Washington School of Medicine, Seattle, WA

Laura Markley, MD, FAPA, FAAP, Akron Children’s Hospital, Akron, OH

Hsiang Huang, MD, Cambridge Health Alliance, Cambridge, MA

Lorin Scher, MD, University of California, Davis School of Medicine, Sacramento, CA

Felicia Wong, MD, Kaiser Permanente, Irvine, CA

Program Tracks

ADP	ADM	BCN	CDE
Addictions and Pain	Administration	Basic & Clinical Neuroscience	Career Development & ECP
EDT	ETH	ITC	MSP
Education & Training	Ethics, Oncology, and End-of-Life Care	Integrated Care	Medical Specialties
NEP	POT	PLI	WMH
Neuropsychiatry	Potpourri	Psychotherapy & Liaison Interventions	Women’s Mental Health

SATURDAY, NOV. 12

SCHEDULE AND PROGRAM DETAILS

GS48 “But She Is Too Young to Die...”: Factors in Deliberating Young Adults as Candidates for Organ Transplant

JW Grand
Ballroom 3

ETH

Mark Nickels, MD, University of Rochester Medical Center, Rochester, NY

Aspen Ainsworth, MD, University of Rochester, Rochester, NY

Ann Russ, PhD, University of Rochester, Rochester, NY

Richard Demme, MD, University of Rochester Medical Center, Pittsford, NY

GS49 Psychodermatology for the Psychiatrist

JW Grand
Ballroom 4

MSP

Daniela Kroshinsky, MD, Massachusetts General Hospital/Harvard Medical School, Boston, MA

Jason Reichenberg, MD, FAAD, University of Texas at Austin, Austin, TX

Sussann Kotara, MD, University of Texas at Austin, Austin, TX

Evelyn Lilly, MD, Massachusetts General Hospital/Harvard Medical School, Boston, MA

Michelle Magid, MD, Austin PsychCare, P.A./ University of Texas Dell Medical School, Austin, TX

Amanda Wilson, MD, Vanderbilt University Medical Center, Nashville, TN

GS50 2016 - Updates in Neuropsychiatry

203/204

NEP

Jose Maldonado, MD, FAPM, FACFE, Stanford University, Stanford, CA

Lawrence McGlynn, MD, Stanford University, San Francisco, CA

Yelizaveta Sher, MD, Stanford University, Stanford, CA

Sheila Lahijani, MD, Stanford University Medical Center, Palo Alto, CA

Renee Garcia, MD, Stanford University Medical Center, Stanford, CA

GS51 What Happens When It Just Doesn't Happen: The Psychiatric Implications of Infertility

211/212

WMH

Ann Chandy, MD, Thomas Jefferson University Hospital, Philadelphia, PA

Andrea Mitchell, MD, Mainline Health System, Philadelphia, PA

Madeleine Becker, MD, FAPM, Thomas Jefferson University Hospital, Philadelphia, PA

11:45 – 1:15 PM

Lunch on your own

11:45 – 1:15 PM

APM SIG Chair's Lunch

408/409

With APM Council representatives; by invitation only



SATURDAY, NOV. 12

SCHEDULE AND PROGRAM DETAILS

1:15 – 2:45 PM

8 Concurrent General Sessions [1.5 CME]

GS52 The Neuroscience Behind Psychogenic Non-epileptic Seizures

203/204

BCN

Diego Coira, MD, FAPA, Hackensack University Medical Center, Hackensack, NJ

Fortunato Battaglia, MD, PhD, Seaton Hall University, South Orange, NJ

Margaret Grady, RN, APN-C, Hackensack University Medical Center, Hackensack, NJ

Magdalena Spariosu, MD, Hackensack University Medical Center, Hackensack, NJ

GS53 Innovative Approaches to ACGME Fellowship Learning Requirements

211/212

EDT

Madeleine Becker, MD, FAPM, Thomas Jefferson University Hospital, Philadelphia, PA

Mark Bradley, MD, NYU School of Medicine, New York, NY

Paul Desan, MD, PhD, FAPM, Yale School of Medicine, New Haven, CT

Daniel Elswick, MD, West Virginia University School of Medicine, Morgantown, WV

Robert Joseph, MD, FAPM, Cambridge Health Alliance, Cambridge, MA

Lisa Rosenthal, MD, FAPM, Northwestern University, Feinberg School of Medicine, Chicago, IL

Terry Rabinowitz, MD, DDS, FAPM, FAPA, FATA, University of Vermont College of Medicine, Burlington, VT

Sejal Shah, MD, Brigham and Women's Hospital, Boston, MA

Marie Tobin, MD, University of Chicago, Chicago, IL

GS54 "I Don't Want to Be the First One to Do It!" – A Bioethics SIG Symposium

Brazos

ETH

Talin Dadoyan, MD, FAPM, University of California UCLA, Sherman Oaks, CA

Saba Syed, MD, FAPM, DFAPA, Olive View-University of California Los Angeles Medical Center, Sylmar, CA

Maria Tiamson-Kassab, MD, FAPM, DFAPA, UCSD Moores Cancer Center, La Jolla, CA

Jaroslava Salman, MD, City of Hope, Duarte, CA

Rebecca Brendel, MD, JD, FAPM, Harvard Medical School, Boston, MA

GS55 Integrated Medicine and Psychiatry Curriculum for Psychiatry Residency Training: A Model Designed to Meet Growing Mental Health Workforce Needs

JW Grand Ballroom 1

ITC

Robert McCarron, DO, University of California Davis School of Medicine, Sacramento, CA

Lorin Scher, MD, University of California, Davis School of Medicine, Sacramento, CA

Jaesu Han, MD, UC Davis, Sacramento, CA

Lydia Chwastiak, MD, FAPM, University of Washington, Seattle, WA

GS56 Rheum with a View: The Immunology of Psychiatry

JW Grand Ballroom 2

MSP

Christina Bilyeu, MD, Kaiser Permanente - Sacramento, Vacaville, CA

Kimberly Hartney, MD, University of South Florida Morsani College of Medicine, Tampa, FL

Katherine Brownlowe, MD, The Ohio State University, Columbus, OH

Anne Gross, MD, FAPM, Oregon Health & Science University, Portland, OR

Greg Sullivan, MD, University of South Florida, Tampa, FL

GS57 Battling Inflammation: The Role of the Psychiatrist in Anti-NMDA Receptor Encephalitis from Diagnosis to Recovery

JW Grand Ballroom 3

NEP

Joseph Kugler, MD, University of Texas-Dell Medical School, Austin, TX

Julie Alonso-Katzowtiz, MD, FAAP, FAPA, Dell Medical School, University of Texas at Austin, Austin, TX

Jason Caplan, MD, FAPM, Creighton University, Phoenix, Phoenix, AZ

R Brett Lloyd, MD, PhD, Northwestern University, Chicago, IL

SATURDAY, NOV. 12

SCHEDULE AND PROGRAM DETAILS

GS58 Not Just Haloperidol: Non-pharmacological Interventions for Psychiatric Emergencies

JW Grand
Ballroom 4
PLI

Scott Simpson, MD, Denver Health Medical Center, Denver, CO

Marla Pidgeon, PMHRN-BC, Denver Health and Hospital Authority, Denver, CO

Christopher Sharp, MD, Denver Health Medical Center, Denver, CO

Allison Hadley, MD, UC San Diego Health, San Diego, CA

Jennifer Murphy, LSW, Denver Health Hospital Psychiatric Emergency Room Services, Denver, CO

GS59 Mastering the Art of Mastering the Data: Redefining the Role of the Expert Clinician in Reproductive Psychiatry

402/403
WMH

Christina Wichman, DO, FAPM, Medical College of Wisconsin, Muskego, WI

Shari Lusskin, MD, Icahn School of Medicine at Mount Sinai, New York, NY

Linda Worley, MD, FAPM, VISN 16 Chief Mental Health Officer, Fayetteville, AR

Judy Greene, MD, Bellevue Hospital Center, New York, NY

Program Tracks

ADP	ADM	BCN	CDE	EDT	ETH
Addictions and Pain	Administration	Basic & Clinical Neuroscience	Career Development & ECP	Education & Training	Ethics, Oncology, and End-of-Life Care
ITC	MSP	NEP	POT	PLI	WMH
Integrated Care	Medical Specialties	Neuropsychiatry	Potpourri	Psychotherapy & Liaison Interventions	Women's Mental Health

2:45 – 3:00 PM

Break

3:00 – 4:30 PM

7 Concurrent General Sessions [1.5 CME]

GS60 Chronic Pain: The Art and the Neuroscience

203/204
ADP

William Jangro, DO, FAPA, Sidney Kimmel Medical College at Thomas Jefferson University, Philadelphia, PA

Mitchell Cohen, MD, Thomas Jefferson University, Philadelphia, PA

Todd Martin, MD, Thomas Jefferson University Hospital, Philadelphia, PA

GS61 Proactive Consultation-Liaison Psychiatric Service: How to Propose, Start and Sustain the 'Behavioral Intervention Team' Model

211/212
ADM

Hochang Lee, MD, Yale School of Medicine, New Haven, CT

Waguhi William IsHak, MD, DFAPA, Cedars-Sinai Medical Center, Los Angeles, CA

Patrick Triplett, MD, Johns Hopkins University School of Medicine, Baltimore, MD

Al Alam, MD, SUNY at Stony Brook, Stony Brook, NY

Christine Finn, MD, Dartmouth Hitchcock Medical Center, Lebanon, NH

William Sledge, MD, DFAPA, FACP, Yale School of Medicine, New Haven, CT

GS62 Tics, Tourette's and Twitches: Neuroscience and Neuropsychiatry of Movement Disorders

Brazos
BCN

Pierre Azzam, MD, FAPM, Western Psychiatric Institute and Clinic of UPMC, Pittsburgh, PA

J. Michael Bostwick, MD, FAPM, Mayo Clinic, Rochester, MN

Erica Greenberg, MD, Massachusetts General Hospital, Boston, MA

Nicholas Kontos, MD, Massachusetts General Hospital, Boston, MA

GS63 Research SIG Presents: What Can APM Do for You!? Research Career Development in Academic Psychiatry

JW Grand
Ballroom 1
CDE

Donald Rosenstein, MD, FAPM, University of North Carolina, Chapel Hill, NC

Jo Ellen Wilson, MD, Vanderbilt University, Nashville, TN

Gen Shinozaki, MD, FAPM, University of Iowa, Iowa City, IA

James Hammel, MD, FAPA, Western University of Health Sciences, Seattle, WA

June Cai, MD, Walter Reed National Military Medical Center, Bethesda, Bethesda, MD

SATURDAY, NOV. 12

SCHEDULE AND PROGRAM DETAILS

GS64 Psychosomatic Medicine Psychiatrists in Palliative Care Across the Lifespan

JW Grand Ballroom 2

ETH

Gabrielle Silver, NewYork-Presbyterian/Weill Cornell Medical Center, New York, NY

Julia Kearney, MD, Memorial Sloan Kettering Cancer Center, New York, NY

Xiomara Rocha-Cadman, MD, Memorial Sloan Kettering Cancer Center, Old Greenwich, CT

Mehak Sharma, MD, Memorial Sloan Kettering Cancer Center, New York, NY

Mary Lynn Dell, MD, DMin, FAPM, DFAACAP, The Ohio State University, Dublin, OH

GS65 Don't Lose Sleep over Insomnia: Brain-Mind-Body Approach Towards Assessment and Management of Insomnia in Psychiatric Patients – An Algorithm for Consultant Psychiatrists

JW Grand Ballroom 3

MSP

Fawad Taj, MD, School of Medicine, Case Western Reserve University, Cleveland, OH

Mansoor Ahmed, MD, FCCP, FABIM, Cleveland Sleep Center, Cleveland, OH

Fareeha Ashraf, MD, Cleveland VAMC, School of Medicine, Case Western Reserve University, Cleveland, OH

Jeffrey Przybysz, PsyD, Louis Stokes Cleveland VA Medical Center, Cleveland, OH

GS66 Global Health SIG: Global Health and Neuropsychiatry – Making Connections with Patients and Their Families Across the Cultural Divide

JW Grand Ballroom 4

PLI

Jose Arriola Vigo, MD, Vanderbilt University Medical Center, Nashville, TN

Carol Larroque, MD, University of New Mexico School of Medicine, Cedar Crest, NM

Marie Rose Alam, MD, Johns Hopkins School of Medicine, Baltimore, MD

James Griffith, MD, FAPM, The George Washington University, Washington, DC

Adel Zaraq, MD, Weill Cornell Medical College in Qatar, Akron, OH

Stephen Nicolson, MD, FAPM, Beth Israel Deaconess Hospital, Plymouth, Plymouth, MA

4:30 – 4:45 PM

Break

4:45 – 5:30 PM

APM Annual Business Meeting

Brazos

APM members only

5:30 – 6:30 PM

Annual Meeting Committee Wrap-up Meeting

401

Committee members only

SUNDAY, NOV. 13

7:30 – 11:00 AM

APM Council Meeting (second)

502/503

Council members & invited guests only

SUNDAY, NOV. 13

SHORT GUIDE TO THE BEST OF AUSTIN

(COURTESY OF APM'S LOCAL ARRANGEMENTS SUBCOMMITTEE)

Restaurants

Austin is foodie central!

BBQ

Often served out of a food trailer with a BBQ pit in the back, open until the meat runs out so get there early...

Franklin BBQ: Voted #1 'Best BBQ in the USA' by Bon Appétit and The Texas Monthly. Be prepared for long waits, 3+ hours, but amazing BBQ.

John Mueller Meat Co.: Served out of a food trailer, Anthony Bourdain called it "Absolutely freaking awesome!" Long wait time, but the owner passes out free beers if the line gets extra-long.

La BBQ: 1906 E. Cesar Chavez St. Amazing BBQ. Free beers Friday thru Sunday and sometimes live music. There's a line, but not as long as Franklins.

Kerlin BBQ: 1700 E. Cesar Chavez St.: Delicious BBQ, shorter lines but meat runs out extra early so get here by 11.

Fancy

Vespaio: (\$\$\$) 1610 S. Congress Ave: Great Italian food and wine.

Uchi: (\$\$\$) 801 South Lamar Blvd.: Best sushi in Austin.

Fonda San Miguel: (\$\$\$) 2330 W. North Loop Blvd.: Delicious traditional Yucetecan and Veracruzano dishes, beautiful traditional ambience with a courtyard in the middle of the restaurant.

Not as fancy

Justine's: (\$\$) 4710 E. 5th St.: Late night French dining with great ambience and bar.

Launderette: (\$\$) 2115 Holly St: Delicious American fare, Austin style, served in converted gas station/laundromat. Also serves brunch.

South Congress Cafe: (\$\$) 1600 Congress Ave.: Daily brunch! With drinks! Voted Best Bloody Mary by the Huffington post.

Getting around/Word of Advice:

- ★ Uber left Austin in a huff but there are still some decent ride-sharing options, including GetMe, Fare, Wingz, Car2Go.
- ★ Taxis are hard to find if you don't start at a hotel.
- ★ If it rains, and people tell you it is flooding, believe them. Stay away from the river when it is raining, even downtown.

Salty Sow: (\$\$) 1917 Manor Rd: American gastropub with a great happy hour. Try the 'crisp chicken thighs' unless you go all out and order the 'milk-braised pork butt'. Michelle Obama stopped here!

El Naranjo: (\$\$) 85 Rainey St: Traditional and delicious Oaxacan cuisine, order the mole.

Swift's Attic: (\$\$) 315 Congress Ave (above Elephant Room bar): small shareable plates, eclectic food.

Cheap

Torchy's Tacos: (\$) Local chain, scattered about Austin, Obama stopped here.

Hideout: 617 Congress Ave: Downtown Austin's oldest independent coffee house, with beer, wine, espresso coffee, and food including vegan ice cream. Happy hour every day 5-7 and all night Wednesday.

Mozart's Coffee Roasters: (\$) 3825 Lake Austin Blvd.: Solid coffee and desserts with amazing views on Lake Austin. Great place to read or work.

Home Slice: (\$) 1415 S. Congress Ave: Texas does not do pizza, except for Home Slice. Thin crust pizza, good place to stop if you're shopping on South Congress.

Ramen Tatsu: (\$) 1234 S. Lamar Blvd. or 8557 Research Blvd: Japanese soul food, Time Out voted it one of 'Best Ramen in America'.

Food trucks: Lots of great food trucks, including East Side King (by guy who won Top Chef), Voodoo Donuts, Vera Cruz for tacos, Burro's Grilled Cheese Truck, Patrizi's, and many more....

SHORT GUIDE TO THE BEST OF AUSTIN



Music

Elephant Room: 315 Congress Ave: Great cocktails and ambience in a historic jazz club downtown.

Continental Club: 1315 S. Congress Ave: Famous club that features rock, country and blues act. Great music anytime.

Saxon Pub: 1320 S. Lamar Blvd.: Great live music.

Broken Spoke: 3201 S. Lamar Blvd: Historic country western dance hall serving beer and chicken fried steak.

Bars

East 6th street is a good place for bars, Rainey St also has good nightlife.

Whisler's Cocktail Bar: 1816 E. 6th St.: Rustic ambience, great cocktails and outdoor patio with occasional live music.

Elephant Room: 315 Congress Ave: Great cocktails and ambience in a historic jazz club downtown. Start with dinner at Swift's Attic upstairs.

Driskill Hotel Bar: 604 Brazos St: Hotel bar located in famous hotel founded by cattle baron in 1886, with great ambience and live music.

Cheer Up Charlie's: 900 Red River St: LGBTQ bar, with indoor/outdoor space, dance parties and drag shows galore.

Entertainment

Esther's Follies: 525 E. 6th St: Modern day Vaudeville theatre, with magic shows, performance art, political satire, and musical acts for grownups.

Activities for Families

Austin Nature and Science Center: Kid friendly strolls and wading, rescued animals to check out, a dino pit where kids can excavate giant dinosaur bones or just play in the sand.

Austin Zoo: 10808 Rawhide Trail: A zoo made up of rescued creatures, everything from lions to wolves to pigs. You can feed the goats, ride a little train or wander the grounds. Bring your own picnic.

Activities for Everyone

South Congress St. has lots of great shopping.

Zilker Park: Walking trails along the river including the start of the 8-mile Barton Springs Greenbelt Trail, as well as great playgrounds, the Zilker Zephyr-a scenic train ride- and a 9-hole disc golf course. Rent a canoe or kayak at Zilker Park Boat Rentals and go turtle spotting.

Mexican-American Cultural Center: 600 River St: Exhibits and events that explore Mexican-American arts and heritage.

Blanton Museum of Art: 200 E. Martin Luther King Blvd.: Small but beautiful contemporary art museum on the University of Texas.

Austin Detours: Several hour food truck crawl as well as many other Austin tours.

Stubb's BBQ Gospel Brunch: 801 Red River St: Buy tickets well ahead for Sunday Gospel Brunch.

Other fun things to do

Go walking, running or biking on the greenway along the Colorado River.

Go kayaking, canoeing, or paddle boating on the Colorado River.

Rent bikes from Mellow Johnny's Bike Shop.

Help keep Austin weird!

COMMITTEE & SIG MEETINGS

(Subject to modification)

On each morning, a continental breakfast will be available in the foyer areas outside the meeting rooms listed below. APM Committee meetings are closed and only members may attend. SIG meetings are open to all.

Thursday, November 10

Room	7:00 – 7:45 AM
402/403	Business of PM Subcommittee
211/212	Bylaws Subcommittee
408/409	Maintenance of Certification Subcommittee
209	Medical Student Education Subcommittee
401	Pre-Conferences Courses Subcommittee
208	Research Subcommittee
213	Global Health SIG
404	Early Career Track Subcommittee
505	Fellowship Education Subcommittee
407	Guidelines & Evidence-Based Medicine Subcommittee

Friday, November 11

Room	7:00 – 7:45 AM	7:45 – 8:30 AM
402/403	Interdisciplinary Education Subcommittee	Cardiovascular Psychiatry SIG
211/212	Oral Papers & Posters Subcommittee	Early Career Psychiatrists SIG
203/204	Residency Education Subcommittee	HIV/AIDS Psychiatry SIG
408/409	Women's Caucus	Women's Health SIG
401	Local Arrangements Subcommittee	Neuropsychiatry SIG
208	Finance Committee	Psychological Considerations SIG
213	Nominating Committee	Telepsychiatry SIG
404	Research & Evidence-Based Practice Committee	Research SIG
505	Journal Committee	Emergency Psychiatry SIG
407	Member Services Subcommittee	Membership Recruitment Breakfast

Saturday, November 12

Room	7:00 – 7:45 AM	7:45 – 8:30 AM
Brazos	Bioethics SIG	Annual Meeting Committee
402/403	Transplant Psychiatry SIG	Pediatric Psychosomatic Medicine SIG
211/212	Education Committee	Fellowship & Awards Subcommittee
408/409	Workshops & Symposia Subcommittee	Governance Committee
203/204	Medicine & Psychiatry SIG	Membership Committee
401	Palliative Medicine & Psycho-oncology SIG	Communications Committee
208		Online Education Subcommittee
JW Grand Ballroom 1		Community-Based Psychosomatic Physician Practice Issues SIG
213	General Hospital Psychiatry Board	



Supporting the Mission of the Academy of Psychosomatic Medicine

In June 2009, the APM Council created a 501(c) (3) charitable, education, and scientific foundation with the primary purpose of supporting the Academy's education and research programs and activities through fundraising. This organization is called the Foundation of the Academy of Psychosomatic Medicine (fAPM).

Annual Funding Campaign

Join us as we kick off our Annual Funding Campaign! ALL contributions, regardless of size, will help us achieve our commitment to future leaders in our field and ensure our continued impact as we move the cause of integrated care forward.

Having full participation sends a strong message about our collective commitment to our mission, enabling us to solicit larger grants from individuals and institutions that have interest in our work. And your gift is tax-deductible!

Educational Mission

The Foundation of the Academy of Psychosomatic Medicine supports the Academy's commitment to:

- Fostering ongoing career development and recognizing significant contributions to the field, through endowed funds like the Lipsitt Award
- Developing leaders in Psychosomatic Medicine, by supporting programs like the Webb Fellowship, which provides younger members with mentorship and opportunities for leadership
- Supporting the academic growth and development of trainees through programs like the Trainee Travel awards, which provide funding for selected trainees to attend the annual meeting
- Support for ongoing access to major researchers in our field for education and mentorship of trainees and early career members. In the spirit and honor of Wayne Katon, whose career was dedicated to clinical research, we invite you to support our newly established Research Support Fund

Donations

Both the Academy and the Foundation thank you for your generous contribution and support. Help us reach our Annual Funding Campaign goal: donations may be made online at apm.org/foundation and click **Donate Now**.

The Foundation's Board of Directors

Carol Alter, MD, FAPM, *Chair*
David Gitlin, MD, FAPM, *Vice Chair*
Nehama Dresner, MD, FAPM, *Secretary/Treasurer*
Robert Boland, MD, FAPM, *APM Council Representative*
Catherine Crone, MD, FAPM, *ex officio*
Linda Ganzini, MD, MPH, FAPM, *consultant*

Bobbi Geiger, MSW, *ex officio*
Christopher Kogut, MD, MSW, FAPM, *consultant*
Philip Muskin, MD, FAPM
Donald Rosenstein, MD, FAPM, *consultant*
Daniel Winstead, MD, FAPM
Linda Worley, MD, FAPM, *ex officio*

MISSED A SESSION? WANT TO REVIEW A PARTICULAR PRESENTATION?

EXPERIENCE The APM 2016 plenary sessions, the full Essentials of Psychosomatic Medicine course, and all Skills Courses online through the **APM LIVE LEARNING CENTER**

Carefully selected sessions from this conference are being recorded and will be available online for all your professional development needs. Recorded sessions make great training tools for you and your colleagues and keep you at the forefront of your industry.

You will be notified via email when sessions have been posted online.

<http://tinyurl.com/APM-LLC>



ACADEMY OF PSYCHOSOMATIC MEDICINE
LIVE LEARNING CENTER

HOTEL MAPS

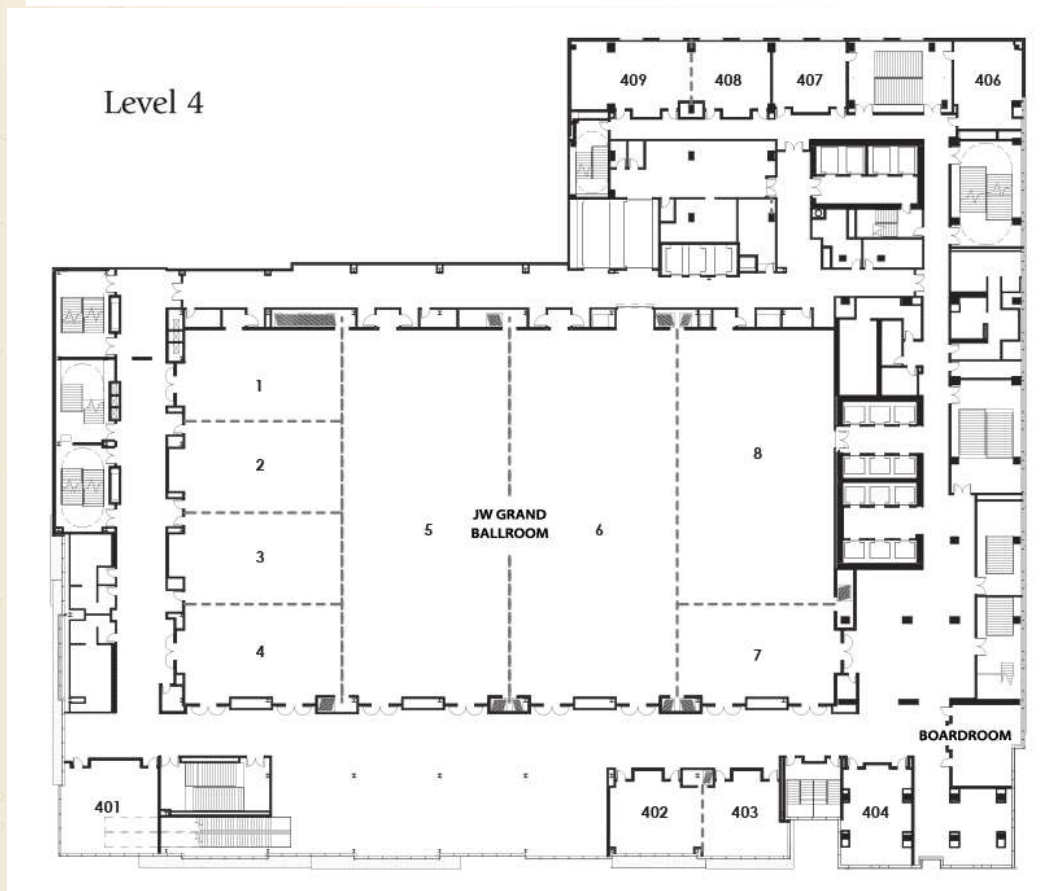

HOTEL MAPS

Level 5



A Guide to Using the APM 2016 App

STEP 1

Download the "APM 2016" app from the Apple App Store or Google Play Store. To start using the app, select "Login" and enter your username (your email) and password (emailed to you).

If you previously created an account using the **APM 2016 Online Planner**, log in with the same username (your email) and password. Don't know your password? Click on "Forgot your password?" to have it emailed to you.



STEP 2

Find the presentation you want quickly and interact with the presentation slides by drawing on slides and highlighting text. Use the note-taking mode to type your notes next to each slide. You will need an internet connection to download all slides but can later view them and take notes on them without one. Access/Print the notes you take by clicking "My Notes" on the main screen or "Online Personal Summary" in the sidebar menu.



STEP 3

If you don't have a mobile device that is able to download the app, you can use your **laptop**. As long as you have an internet connection, you can take notes on presentations through your laptop, or access slides following the conference on a laptop or desktop via the following website link: tinyurl.com/APM2016

If you already have an account on a mobile device, use the same account information that was emailed to you. Otherwise follow the steps to create an account.



APM DISCLOSURE REPORTING

The Academy of Psychosomatic Medicine requires disclosure by all program planners and presenters of CME activities of any financial or other affiliation with commercial organization(s) that may have a direct or indirect interest in the subject matter of the educational activity. A “financial interest” may include, but is not limited to: being an employee and/or being a shareholder in the organization; being on retainer with the organization; or having research or honoraria paid by the organization. An “affiliation” may include holding a position on an advisory committee, speakers’ bureau or some other role or benefit to a supporting organization.

APM administers a process by which potential conflicts are identified and resolved prior to the educational activity. Furthermore, the audience of each session must be informed of the presenters’ or program planners’ affiliations with every commercial interest by acknowledging such in the printed program and orally or visually (incorporated into slide presentation) at the start of a session.

APM only identifies active disclosure information, meaning that the absence of a speaker from this list indicates that neither they, nor an immediate member of their family have any financial relationships or potential conflict of interest to disclose.

Program Participant	Disclosure
Kathleen Bell, MD	Avanir (Advisory Committee/Board Member). Study funding: US Dept. of Defense
Jordi Blanch, MD, PhD	Ferrer Corporate (Honorarium); Janssen (Other Financial or Material Support); Pfizer (Other Financial or Material Support)
Nancy Byatt, DO, FAPM	Massachusetts Department of Mental Health (Medical Director, MCPAP for Moms) (Grant/Research Support). Study funding: The Massachusetts Department of Mental Health and the National Center for Research Resources and the National Center for Advancing Translational Sciences, National Institutes of Health, through Grant KL2TR000160 and KL2TR001454.
Jason Caplan, MD, FAPM	AssureRx Health (Speaker’s Bureau); Avanir Pharmaceuticals (Speaker’s Bureau); Otsuka Pharmaceuticals (Speaker’s Bureau)
Arthur Carlin, MD	Blue Cross Blue Shield/Blue Care Network (Honorarium)
Lee Cohen, MD	Alkermes, Inc. (Grant/Research Support); AstraZeneca (Grant/Research Support); Bristol-Myers Squibb/Otsuka (Grant/Research Support); Cephalon, Inc. (Grant/Research Support); JDS Therapeutics LLC (Advisory Committee/Board Member); National Institute of Mental Health (Grant/Research Support); National Institute on Aging (Grant/Research Support); National Institutes of Health (Grant/Research Support); Ortho-McNeil Janssen (Grant/Research Support); Sunovion Pharmaceuticals, Inc. (Grant/Research Support); Takeda/Lundbeck (Grant/Research Support). Study funding: Bayer
John Cromwell, MD	Apervita Inc. (Consultant); Dell Inc. (Consultant)
Andrew Currivan, MSN	Queens Medical Center (Employee)
Mary Lynn Dell, MD, DMin, FAPM	American Psychiatric Press (Honorarium); Oxford University Press (Honorarium)
John Denninger, MD, PhD	Basis/Intel (Grant/Research Support); Onyx/Amgen (Grant/Research Support)
Graham Emslie, MD	Allergan (Consultant); Duke University (Grant/Research Support); Forest Laboratories (Grant/Research Support); INC Research (Consultant); Lundbeck (Consultant); NCS Pearson (Consultant); Neuronetics, Inc. (Consultant); Otsuka (Consultant); Pfizer, Inc. (Consultant); Texas Department of State Health Services (Consultant). Study funding: National Institutes of Health; University of Alabama at Birmingham
Marlene Freeman, MD	GOED (medical editing); Janssen/Johnson & Johnson (Independent Data Safety Monitoring Committee); Jaymac (Grant/Research Support); JDS therapeutics (Advisory Committee/Board Member); Sage (Advisory Committee/Board Member); Sunovion (Advisory Committee/Board Member); Takeda (Grant/Research Support)
Anne Gross, MD	Spouse employed as brand manager by Atrium Innovations, a manufacturer of nutritional health products; ingredients used by Atrium Innovations, in their products, are similar to some of the supplements discussed in the presentation.

APM DISCLOSURE REPORTING

David Hamilton, MD	Takeda (Grant/Research Support)
Matthew Hotopf, MRCPsych, PhD	UCB, Merck, Lundbeck, Janssen, Biogen (Grant/Research Support); Janssen (Honorarium)
Hsiang Huang, MD	CMS Transforming Clinical Practice Initiative (Honorarium)
Hadine Joffe, MD	Merck (Consultant/Grant/Research Support); Mitsubishi Tanabe (Consultant); NeRRe Therapeutics (Consultant); Noven (Consultant). Study funding: Bayer.
Roger Kathol, MD, FACP	Cartesian Solutions, Inc. (Employment, Intellectual Property / Patents, Major Stockholder (not including mutual funds))
Semmie Kim, MPH	Bayer (Grant/Research Support)
Mallika Lavakumar, MD	Nova Science Publishers (I am editing a book that will be published by Nova Science and will receive and honorarium in the future (Honorarium)); Oakstone (I received an honorarium in 2016 from Oakstone for an educational talk (Honorarium)). Study funding: U.S. Department of Health and Human Services, Health Resources Service Administration H97HA27429-01-00.
Scott Letendre, MD	Cipla (Advisory Committee/Board Member); Gilead Sciences (Grant/Research Support); Janssen (Honorarium); ViiV Healthcare (Grant/Research Support). Study Funding: NIMH.
Robert Lloyd, MD, PhD	iHuman (Consultant; Other Financial or Material Support)
Shari Lusskin, MD	Pfizer (Consultant regarding sertraline and venlafaxine litigation)
Michelle Magid, MD	Allergan Pharmaceuticals (Advisory Committee/Board Member); Ipsen Innovation (Honorarium)
Paul Maruff, PhD	Cogstate (Employment)
Cheryl McCullumsmith, MD, PhD, FAPM	Janssen (Advisory Committee/Board Member)
Roger McIntyre, MD, FRCPC	Astra-Zeneca (Grant/Research Support, Speaker's Bureau, Advisory Committee/Board Member); Bristol-Meyers Squibb (Advisory Committee/Board Member); Eli Lilly (Grant/Research Support, Speaker's Bureau, Advisory Committee/Board Member); France Foundation (Advisory Committee/Board Member); GlaxoSmithKline (Advisory Committee/Board Member); Janssen-Ortho (Grant/Research Support, Speaker's Bureau, Advisory Committee/Board Member); Lundbeck (Grant/Research Support, Speaker's Bureau, Advisory Committee/Board Member); Merck (Speaker's Bureau, Advisory Committee/Board Member); Organon (Advisory Committee/Board Member); Pfizer (Grant/Research Support, Speaker's Bureau, Advisory Committee/Board Member); Shire (Grant/Research Support, Advisory Committee/Board Member)
Tiffany Moore Simas, MD, FACOG	MCPAP for Moms (I am the lead obstetric liaison for MCPAP for Moms and receive a \$5,000/yr stipend for work performed (Other Financial or Material Support)). Study Funding: NIMH.
Roy Perils, MD	Genomind (Advisory Committee/Board Member); Nestle Health (Advisory Committee/Board Member); Psybrain (Advisory Committee/Board Member); RIDVentures (Other Financial or Material Support)
Whitney Peters, MD	Bayer (Grant/Research Support)
Michael Peterson, MD, PhD, FAPM	eMedicine Health / WebMD (Honorarium)
Anna Ratzliff, MD, PHD	Wiley (Royalties from Integrated Care book paid to department (Other Financial or Material Support))
Divy Ravindranath, MD	APP Inc (Royalties from textbook sales)
Donald Rosenstein, MD, FAPM	Oxford University Press (Honorarium); UpToDate (Honorarium)
Leslie Scouff, MD	Philips Healthcare (Honorarium)
Sanjeev Sockalingam, MD, FRCPC, FAPM	Shire Pharmaceutical (Grant/Research Support)
Theodore Stern, MD, FAPM	Academy of Psychosomatic Medicine (Editor, Psychosomatics (Employment))
Rima Styra, MD, FRCPC	Pfizer (Honorarium, Advisory Committee/Board Member)
Mark Sullivan, MD, PhD	Opioid REMS program companies (Grant/Research Support). Study Funding: Patient-Centered Outcomes Research Institute.

5th

ANNUAL SCIENTIFIC
CONFERENCE
OF THE EUROPEAN
ASSOCIATION OF
PSYCHOSOMATIC
MEDICINE · EAPM

47^o

CONGRESO
DE LA SOCIEDAD
ESPAÑOLA DE
MEDICINA
PSICOSOMÁTICA
SEMP

28th June
to 1st July

2017

BARCELONA
WTC Barcelona

www.eapm2017.com

BRIDGING THE GAP BETWEEN
SOMA AND PSYCHE



ORGANIZED BY:

SOCIETAT CATALANA
DE PSIQUIATRIA
I SALUT MENTAL

 SEMP | Sociedad Española de
Medicina Psicosomática

EAPM
The European Association of
Psychosomatic Medicine



***Beyond cognitive behavior therapy:
A revolutionary approach to improve
psychological well-being***

Giovanni A. Fava

Well-Being Therapy

**Treatment Manual and
Clinical Applications**

Well-Being Therapy (WBT) is the psychotherapeutic approach developed by Giovanni Fava, a world-renowned psychiatrist and psychotherapist. WBT is an innovative strategy that is based on monitoring psychological well-being, whereby the patient progressively learns how to make it grow. This type of therapy has enjoyed much success and is increasing in popularity around the world. It is therefore not just of interest to professionals but also to counselors, educators and patients.

XIV + 148 p., 6 fig., 66 tab., soft cover, 2016
CHF 33.00 / EUR 31.00 / USD 34.00
ISBN 978-3-318-05821-5

***'The publication of this first book on
Well-Being Therapy (WBT) is a landmark event.'***

Jesse H. Wright (University of Louisville, Ky.)

For easy ordering please go to
www.karger.com/well-being

Prices subject to change, VAT not included
EUR prices for eurozone countries,
USD price for USA and Latin America

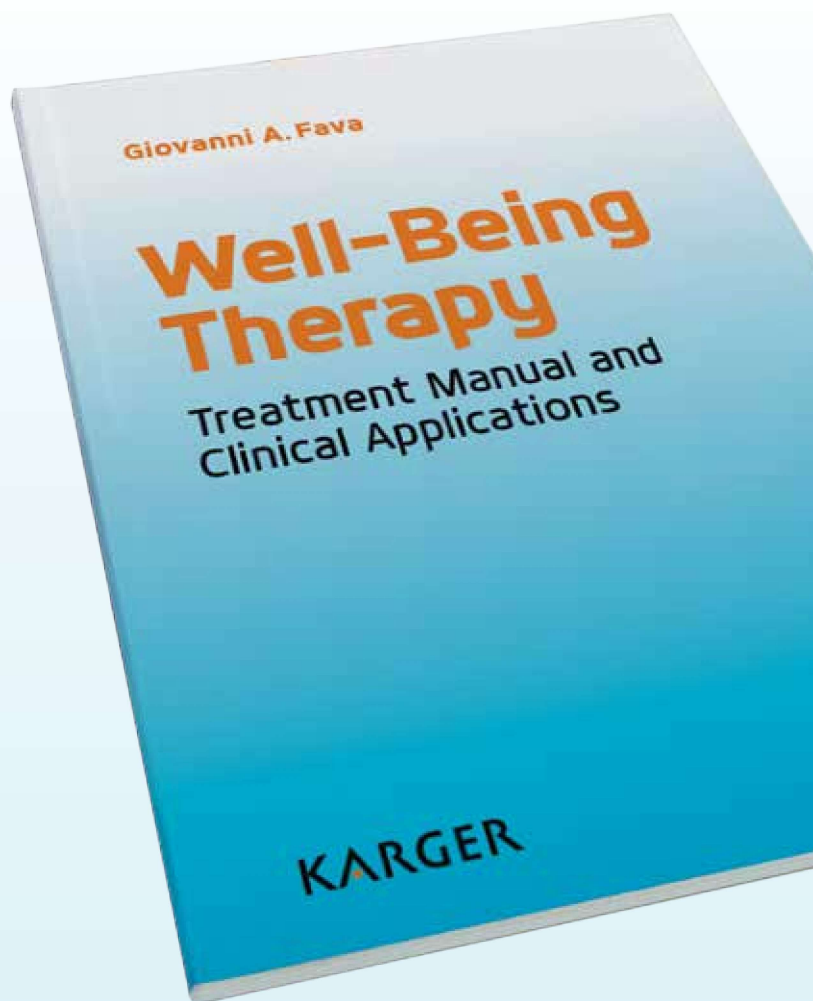

***A unique journal with a top SCI ranking
of 7.632***

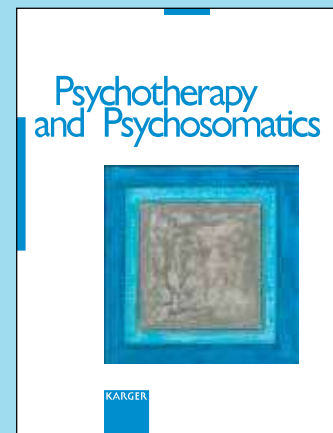

Psychotherapy and Psychosomatics
Editor: **Fava G.A.** (Bologna)

More information at **www.karger.com/pps**

KARGER

K116363_APM



Membership Has its Benefits!

JOIN APM NOW!

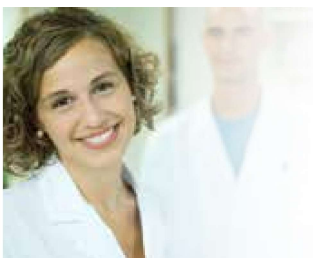

Since 1954, the Academy of Psychosomatic Medicine has served as a meeting ground for collaboration and exchange of knowledge and ideas in the field of psychosomatic medicine and consultation-liaison (C-L) psychiatry. We welcome and encourage professionals and trainees with an interest in consultation-liaison psychiatry/psychosomatic medicine to become a member of the APM. For membership details, please visit www.apm.org to join and start receiving some of the great membership benefits listed below.

AS A MEMBER YOU RECEIVE THE FOLLOWING:

- A subscription to our premier medical journal, *Psychosomatics*, online access to two additional related journals, and 25% discount on selected books published by Elsevier, Inc.
- An annual scientific meeting. Members save over 25% on annual meeting registration fees.
- Introduction to and interaction with special interest groups.
- Opportunities to participate in the Academy's committee structure.
- A distinguished Fellowship and awards program.
- The Academy's newsletter.
- Increase your knowledge & network with your peers and leaders in the field of Psychosomatic Medicine.

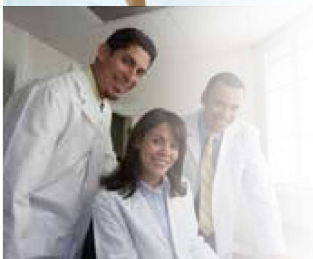

Interested in joining? Please speak with a member of staff at the registration desk.

EXHIBITORS

APM is pleased to welcome to this year's meeting the following companies as exhibitors:

Allina Health, Minneapolis, MN
American Board of Psychiatry and Neurology, Buffalo Grove, IL
American Professional Agency, Inc., Amityville, NY
American Psychiatric Association Publishing, Arlington, VA
Elsevier, Inc., Philadelphia, PA
Harvard Medical School Center for Bioethics, Boston, MA
Norton Medical Group, Louisville, KY
Professional Risk Management Services, Arlington, VA
Southcentral Foundation, Anchorage, AK
UT Southwestern Medical Center, Dallas, TX

SESSION AND MEETING EVALUATIONS

Session and meeting evaluations are now only available online; APM no longer provides paper versions. You can complete your evaluations either using the "Evaluation" section of the meeting app, or from your PC log-on to tinyurl.com/APM2016-eval.

CME certificates are only available using the app or online service; there are no printed CME certificates available. CME certificates are only provided with the completion of your session and meeting evaluations.

APM 2017

Palm Springs, CA Nov 8-11, 2017

Community. Collaborative. Knowledge.

Addressing Current Dilemmas in Psychosomatic Medicine:
Consultants Consulting the Experts



ACADEMY OF
PSYCHOSOMATIC
MEDICINE